

**DB**

**Draper**

**Horn Bed**

**Sussex, UK**

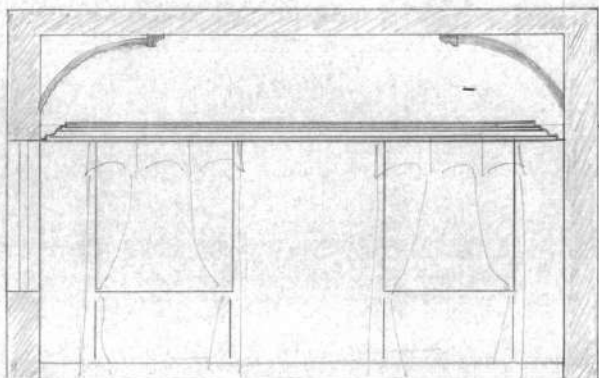

WINDOW ELEVATION

Simon + Françoise  
Bedroom



Feb '89  
1:50.

Bed 1.70m wide  
x 2.00m.

? Sure don't want  
watch TV bed.

Make so easily can  
sleep either end.

Where sun rise

? magnetic north/south.

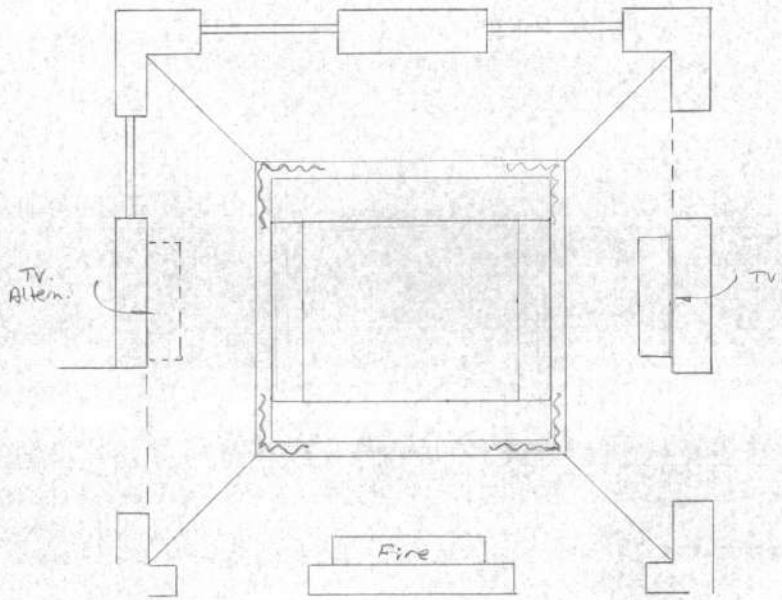

Simon + Françoise  
Bedroom



1:50  
Feb '89.

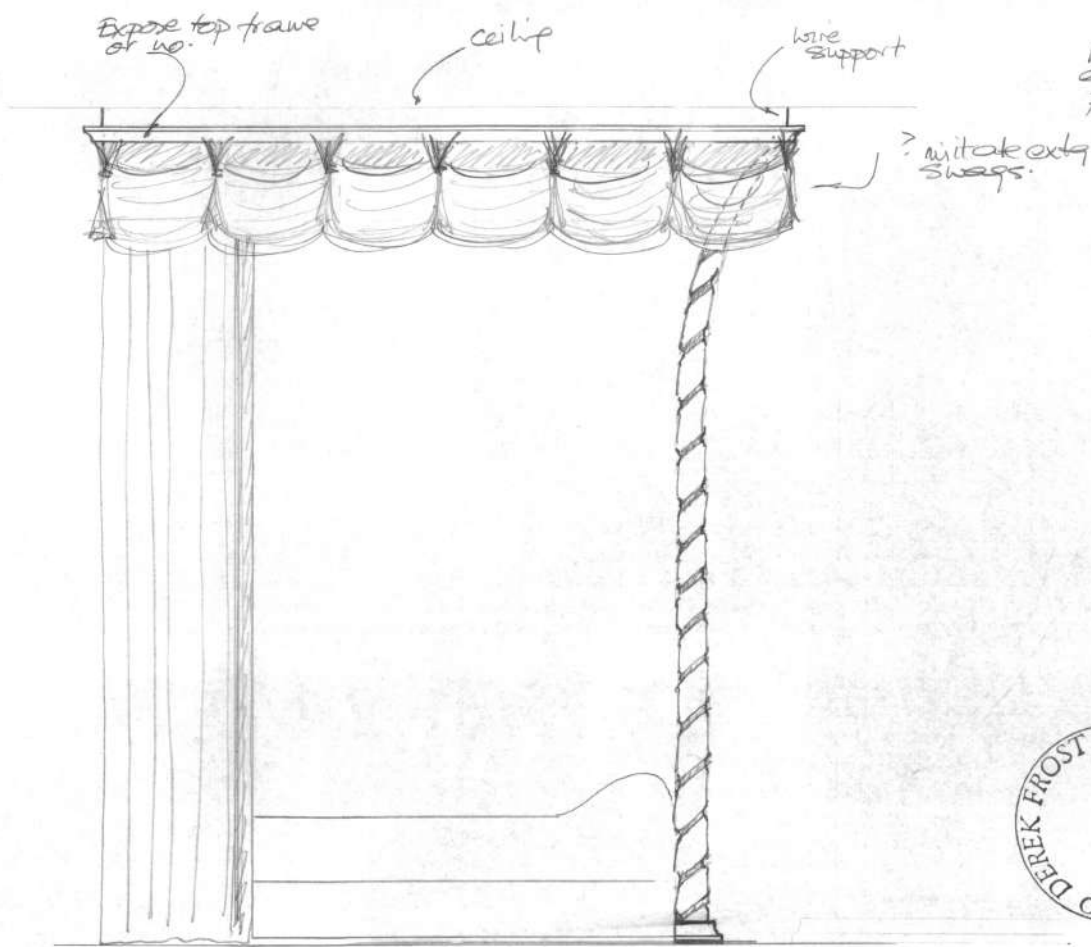

Expose top frame  
or no.

ceiling

wire  
support

? mitak extg  
swags.

12.  
What size are  
existing crtu.  
pellets,



Bed for Simon + Françoise

1:20  
Feb '89

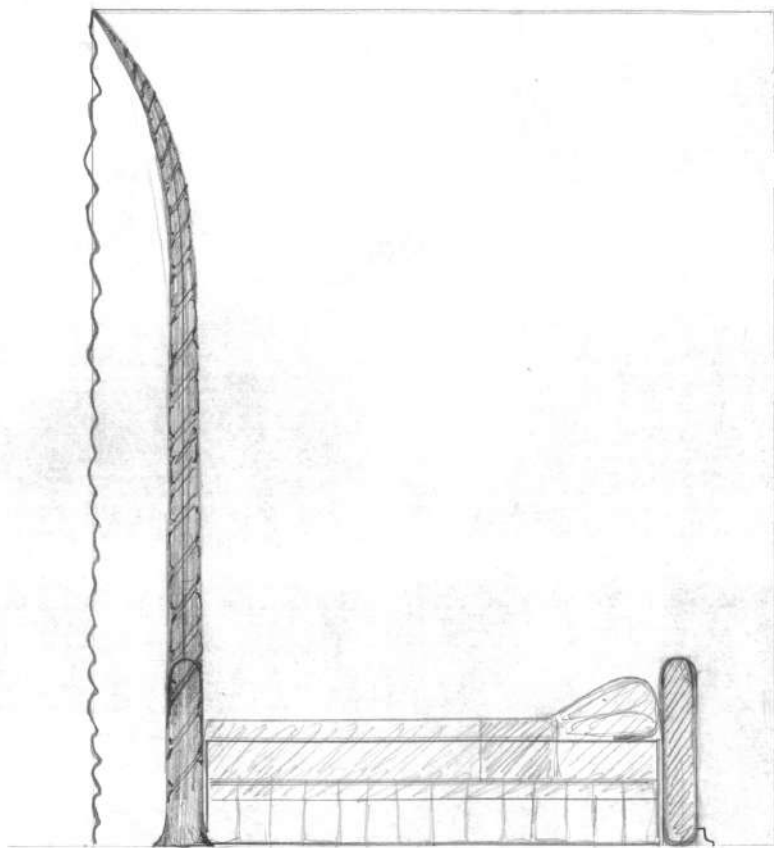

Bed for Simon + Françoise

1:20  
Feb '89.

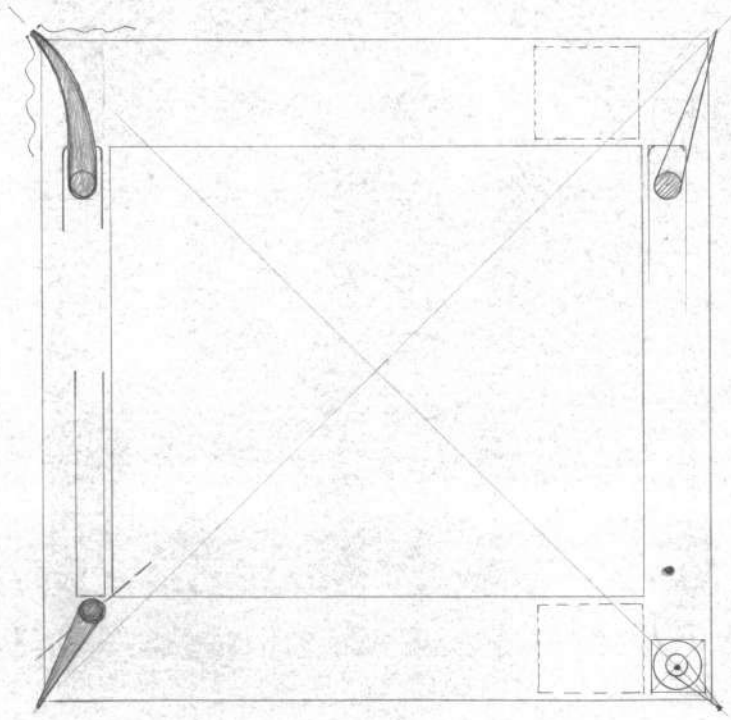

Bed for Simon + Françoise



1:20  
Feb '89.

Alternative Axis Bed.



8.

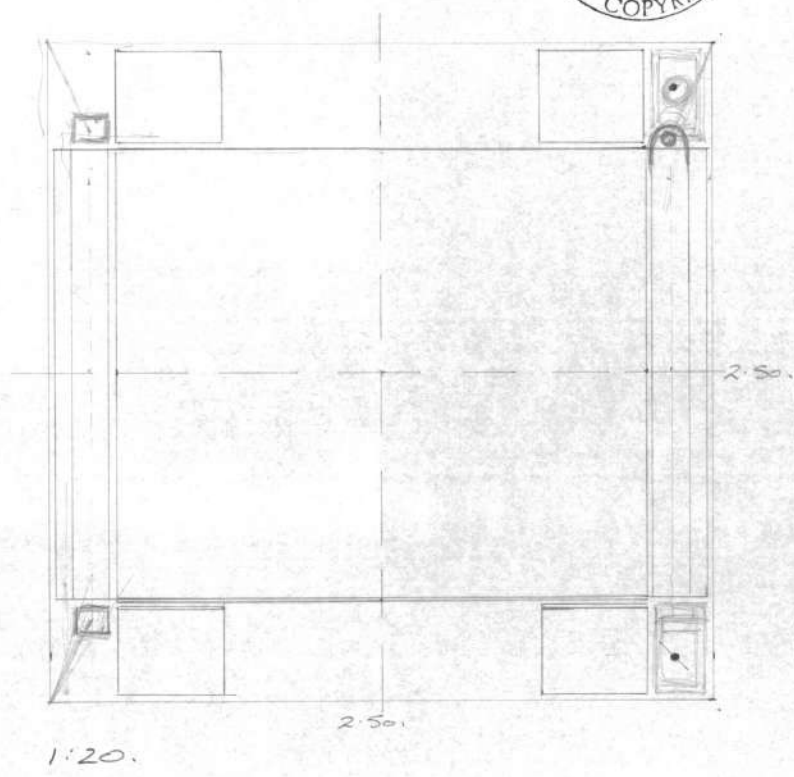
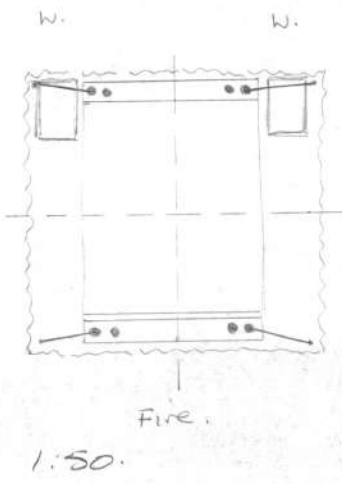

Bed for Simon + Françoise

Feb 1989.

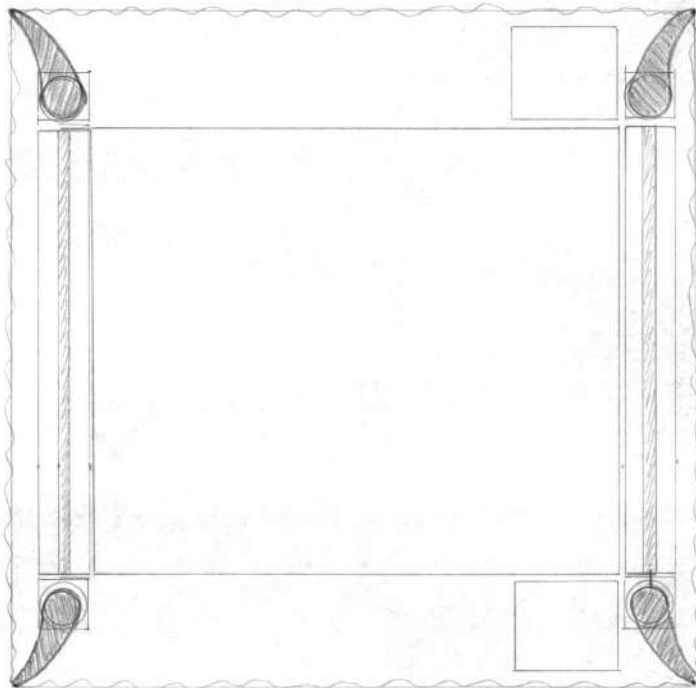

Bed for Simon + Françoise



1120  
Feb '89.



7.

Crtng easily adjustable  
width - big range.

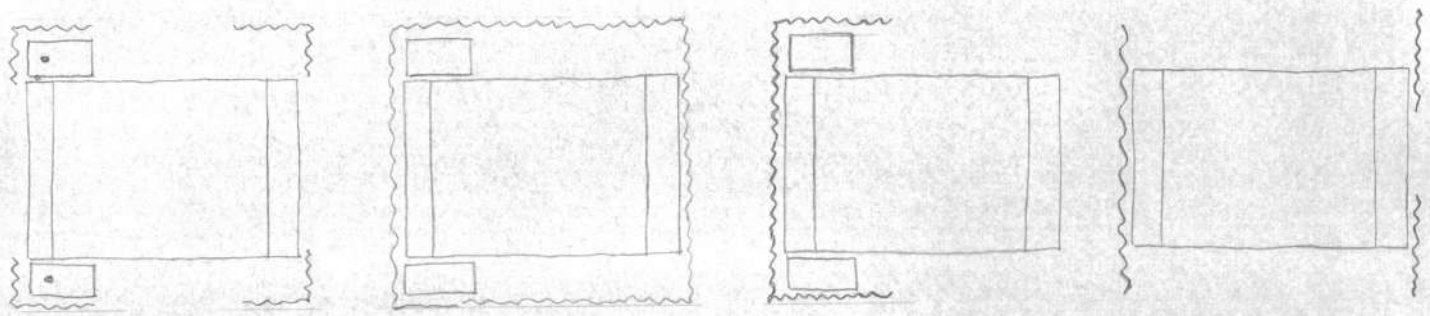

Bed for Simon + Françoise



Feb 189  
1:50.

make 4 curtains but can all come together or all separate any part of track  
 ? High Contrast colour lining  
 ? outer curtains same colour as extg to form corridor  
 develop colour 1 extg. 2-3.

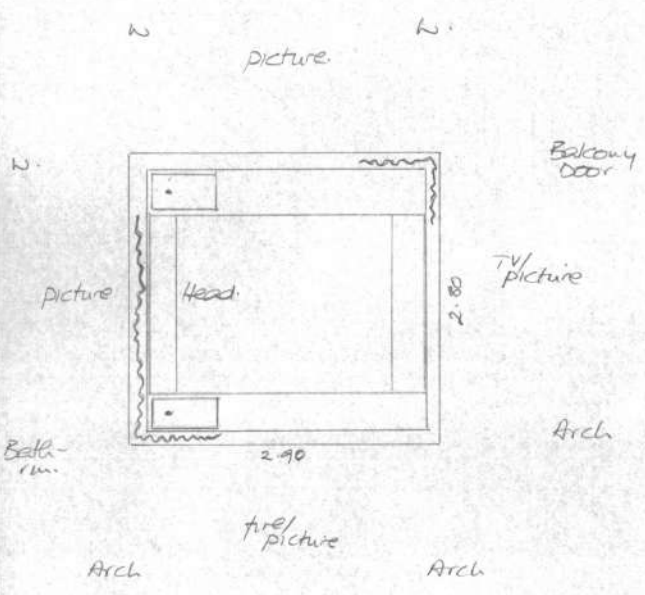

Simone + Françoise bedroom.

Scale 1:50  
Feb '89.

picture.

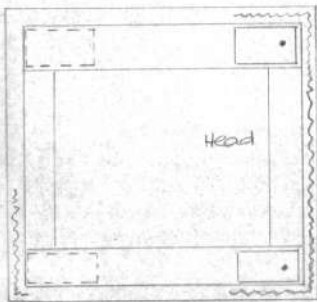

picture.

tree picture

Curtains Fullness? (v. frail but black out)

no mirror

Curtain can be at any place on track

11m + 3m curtains or between  
TV monitor moveable (2 positions)

Curtain mechanical or no:  
- no more romantic.

Under bed supply light/ audio control  
- TV control remote.

- can always see fire



Simon + Françoise  
bedroom.

scale 1:50  
Feb '87.

New curtains "abstract"  
relationship with extg  
curtains.

? mirror behind moveable  
audio/TV unit.

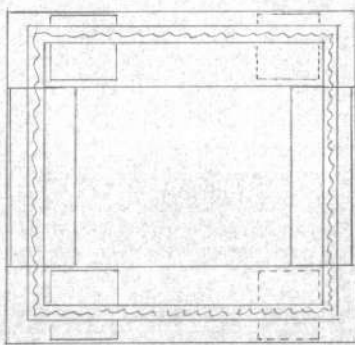

kept  
out?  
bedside tables  
65cm W x 60 dp



Simon + Françoise  
Bedroom

Scale 1:50  
Feb '89.

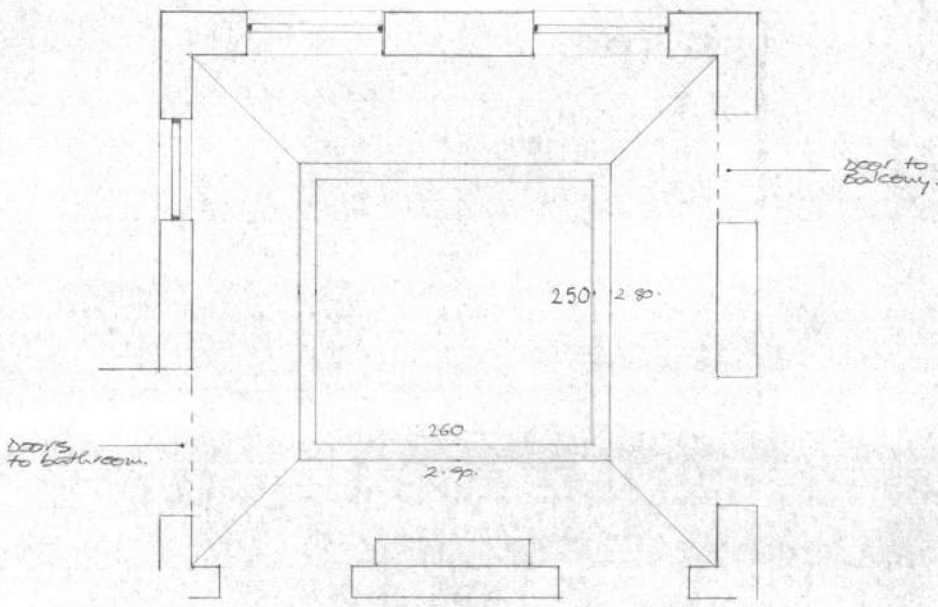

PLAN

Simon + Françoise  
Bedroom.



Feb '89.  
11.50.

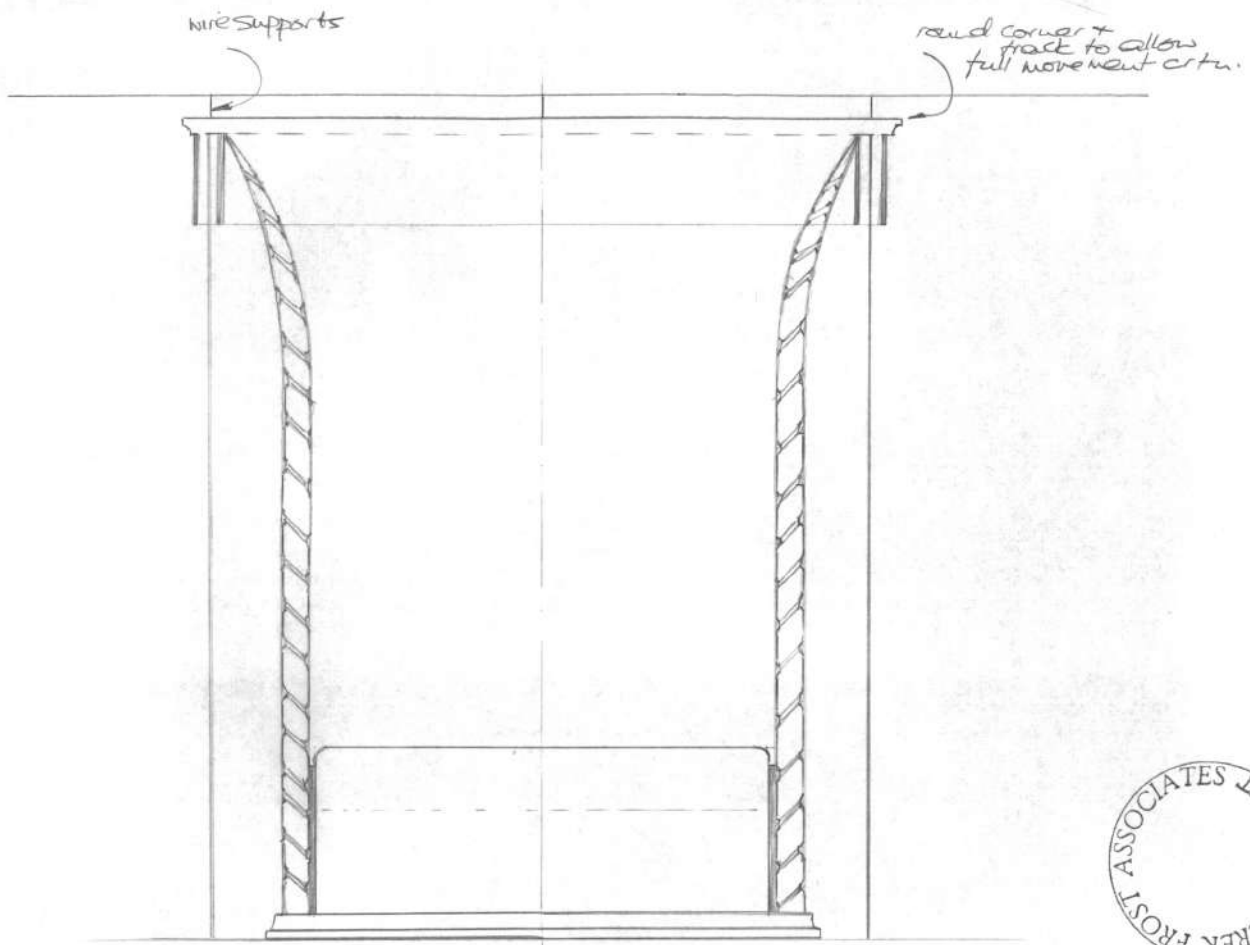

Bed for Simon + Françoise



1:20  
Feb '89.

Alternate Horn Shapes (Narwhal tusk is straight)

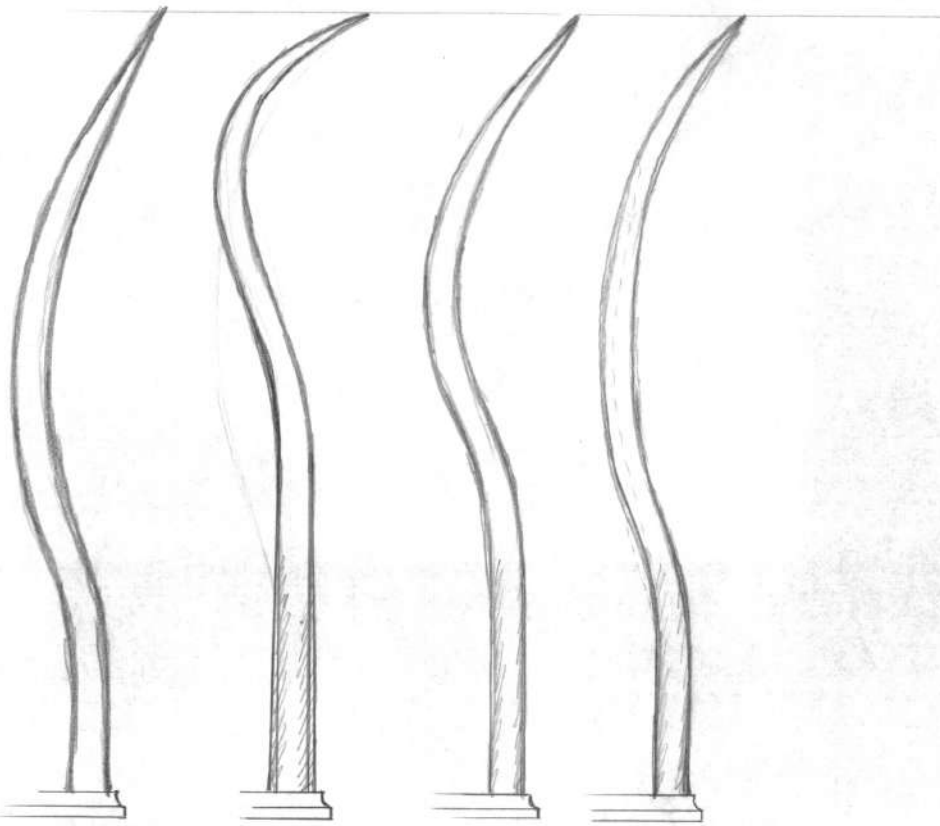

Bed for Simon + Françoise



1:20  
Feb '89

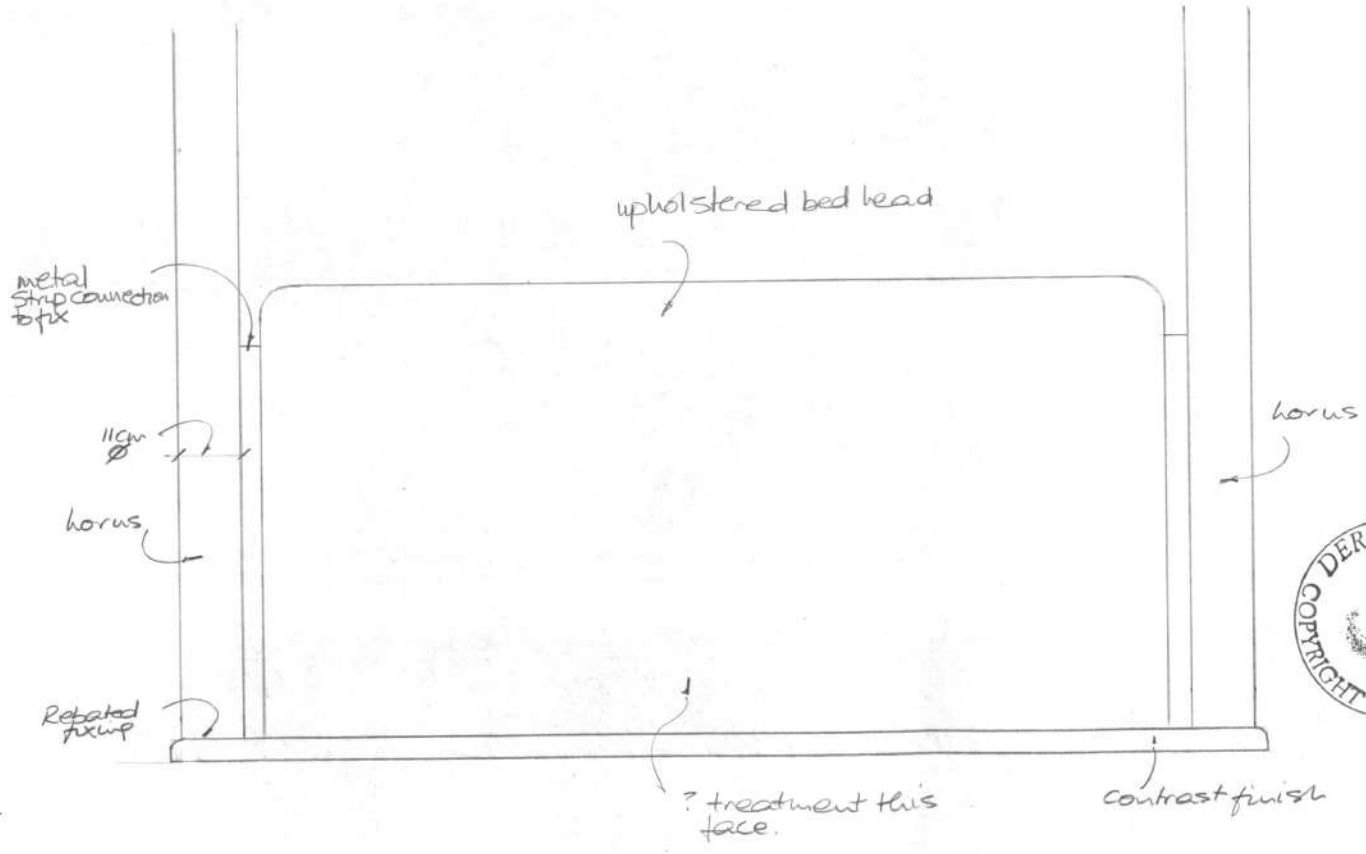

End elevation Bed head/posts  
 Bed - Simon + Françoise

1:10.  
 April '89.





? Anthony Radwile work  
? Finish  
? Has horn like (Kudu)  
? palm tree like  
Find fabrics - sharpest  
green with black green

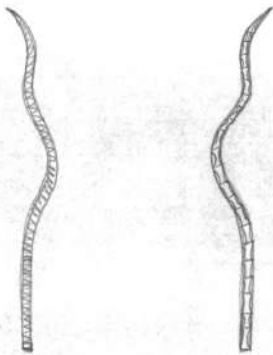

(contact Elton John -  
enquire happy with  
Volume Table)?

N.B - Small width bed side tables  
40 cm max wide (maybe 30 cm)

? SAF - fix  
Canvas to coil up  
above bed

? Swapped pelmet  
to match curtains  
- (problem mismatch  
or plaver/starter  
- preferred?

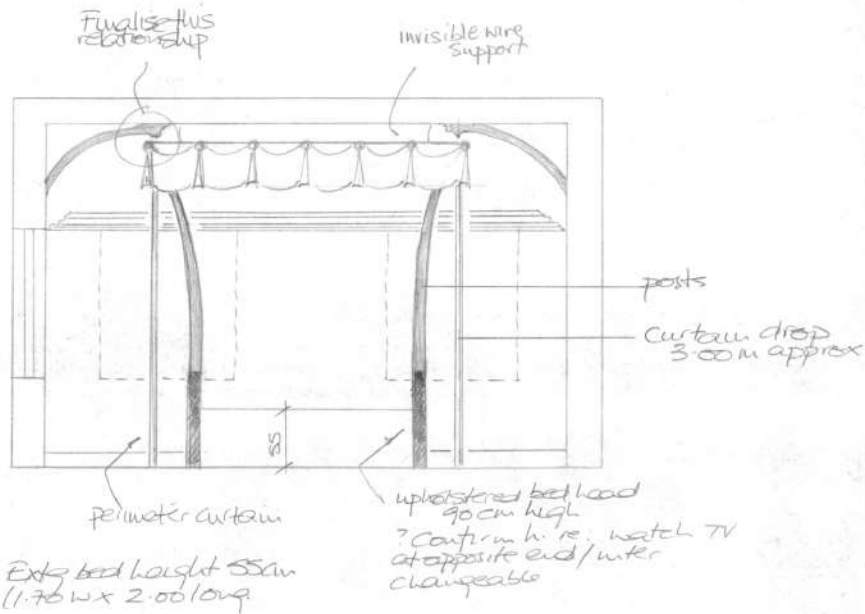

March 1997  
1:50.

- Disadvantage approx max width bed side tables only 350mm - adequate
- Less going (Curve to horns)

Express ext. arch/cornice/cleaver taller relationship to ceiling

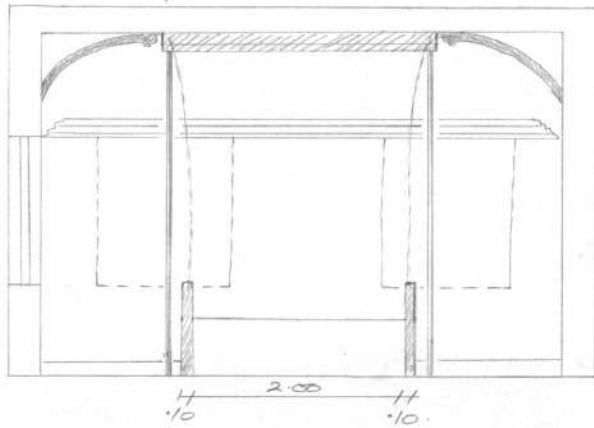

Express highest level cornice/cleaver? hand picture? - if yes how light.

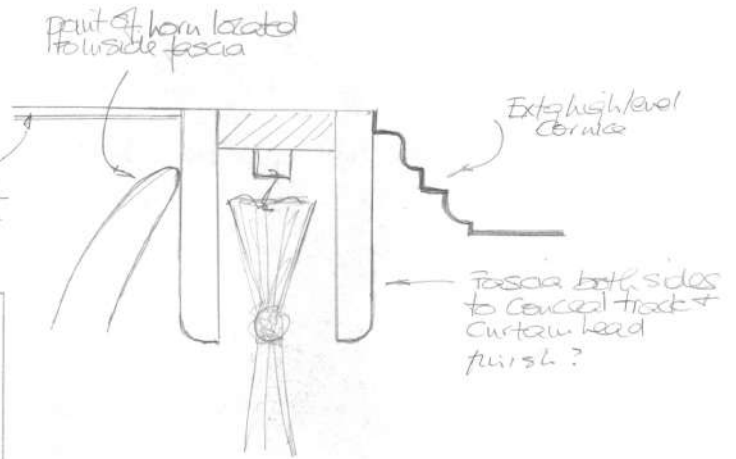

- Preferred /cleaver/ taller/ doesn't obscure ext. detail
- smaller internal space with curtain



March 189  
1:50

Free form all 4 different ways/  
? spiral up

? How light inside  
bed re. ready up etc..

? reduce character  
in a door? or  
inside only?

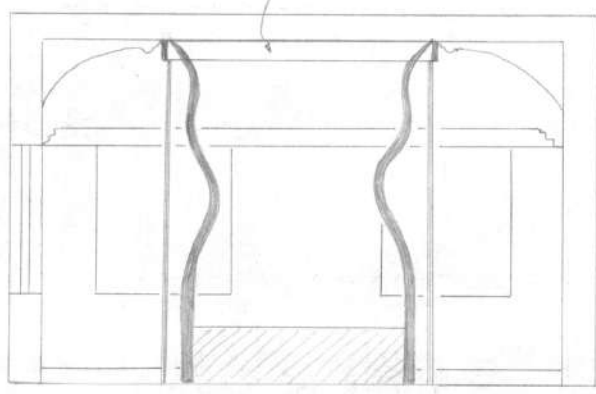

Bed for Simon + Francoise



March '89  
1:50

? re: concealed reading lights

3

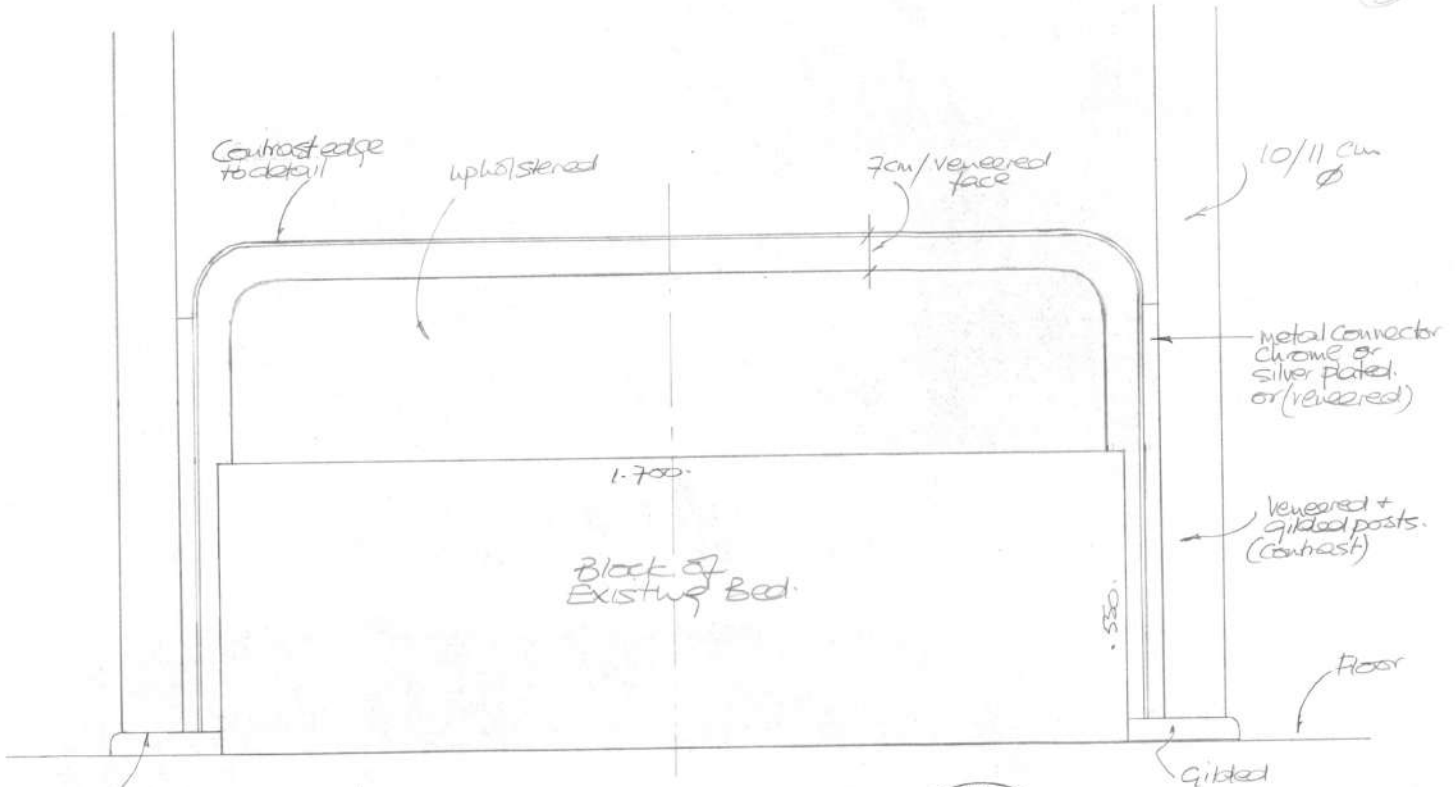

Bed for Simon + Françoise



Scale: 1:10  
date: May 1989.

2

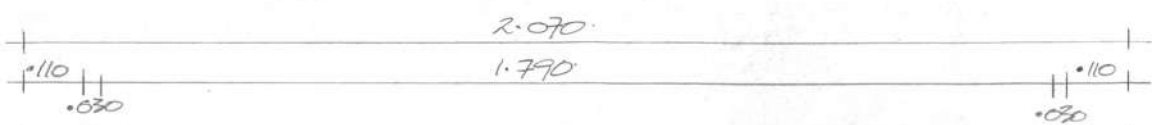

Gilded Edge to Detail (or contrast)

(or contrast) Veneered + gilded posts

Metal connector - chrome or silver plated or veneered

Post/Inset supported in gilded base (contrast)

Floor.

Gilded/or Contrast

Elevation Outside Face  
Bed for Simon + Françoise



Scale: 1:10  
date: 7/24/89.

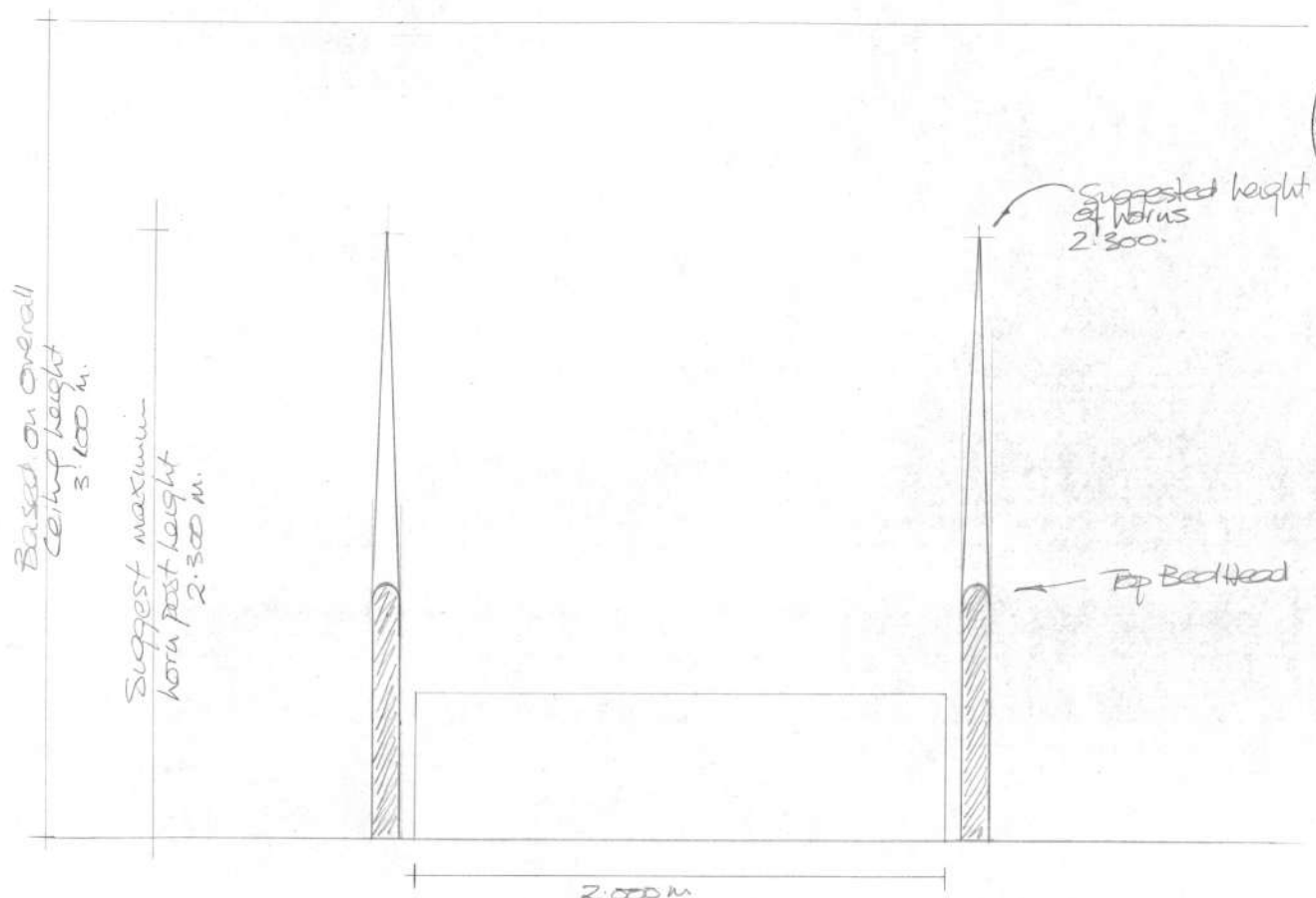

Bed for Simon + Françoise  
at Newkto

1:20  
17/04/89.



Rebrano + Satinwood ?  
- select liny veneer to express direction.

↑  
Spiral  
Marquetry  
Continuum  
up post

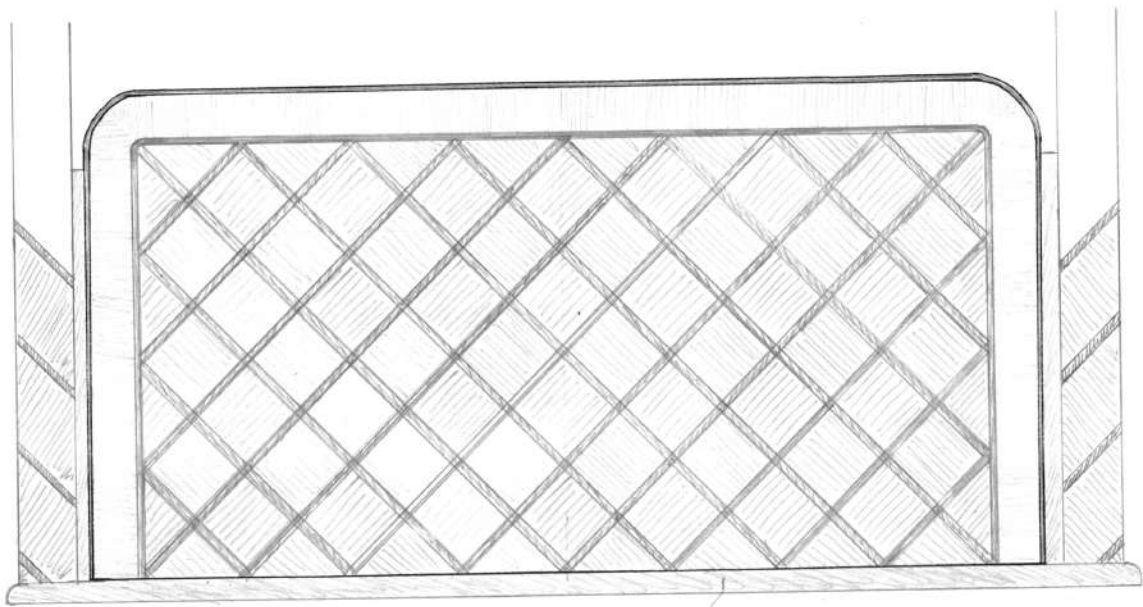

↑  
Spiral  
Marquetry  
Continuum  
up post

Contrast  
base

Marquetry Pattern  
Elevation Outside Face  
Bed for Simon + Françoise

scale 1:10  
date 7/27/89.





Contrast tip  
to horn  
30 cm. long.

Overall height

2.45 m.

Start tip  
at 10cm  
Ø

Horn Bed

Scale 1:10  
date Sept. 89.

8

Colup

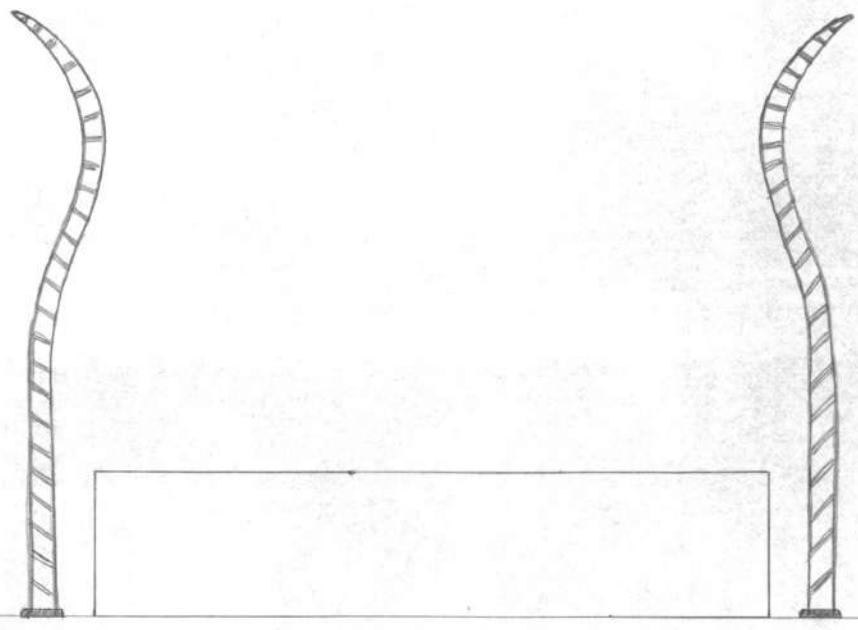

Floor

Section AA - Showing Direction of Horn Posts  
Diagonal pointing out from corners.  
Bed for Simon + Françoise

1:20  
17 May '89

7



Desired  
Shape/ on  
Molder

Top of  
Post.

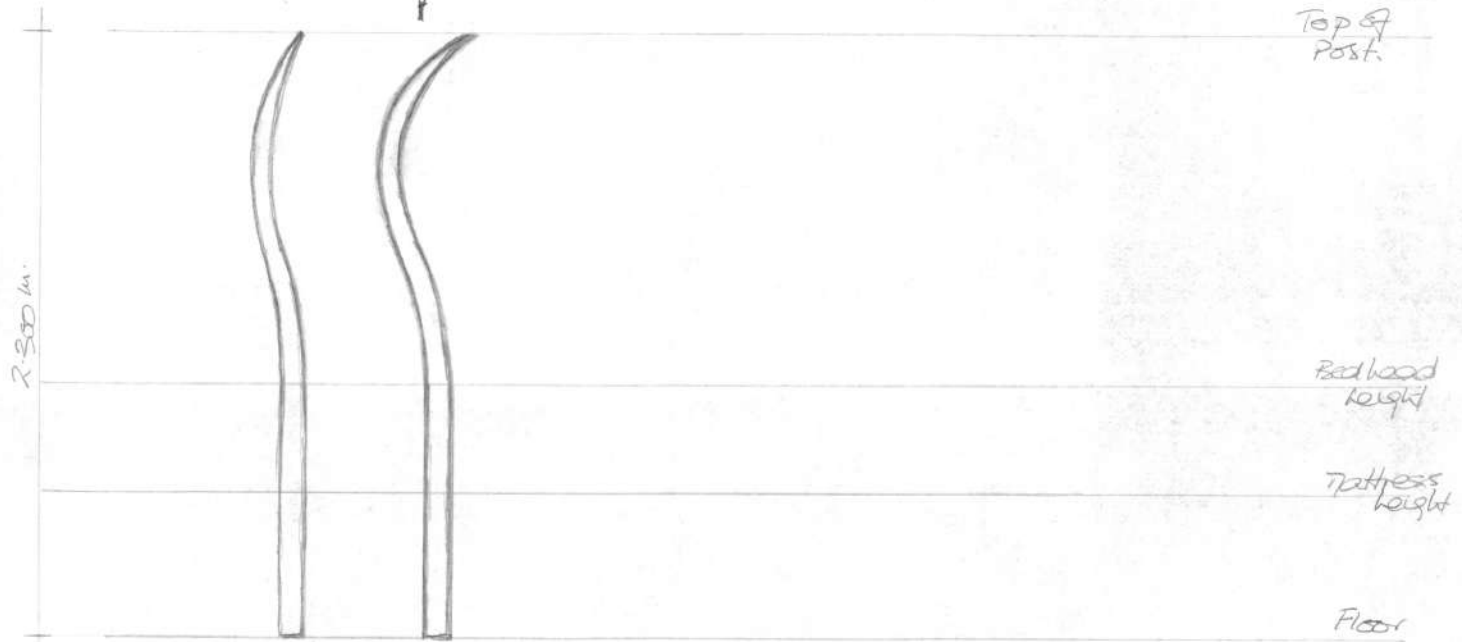

Alternate Horn Shapes  
Bed for Simon and Françoise

1:20  
17 May '89.



Height of raised portion ceiling

Bed to incorporate 4 (40") outward pointing identical horn posts in hardwood.

2.45m overall height of horn post

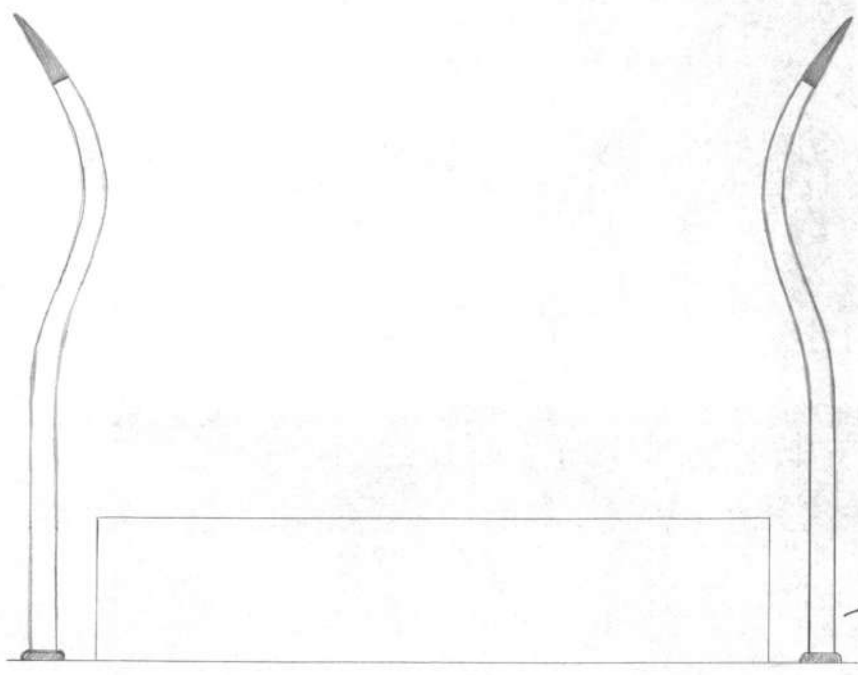

100mm Ø

Section AA - Showing Direction of Horn Post Diagonal pointing out from Carvers Bed for Simon + Françoise

Scale: 1:20 Date: June 1997.

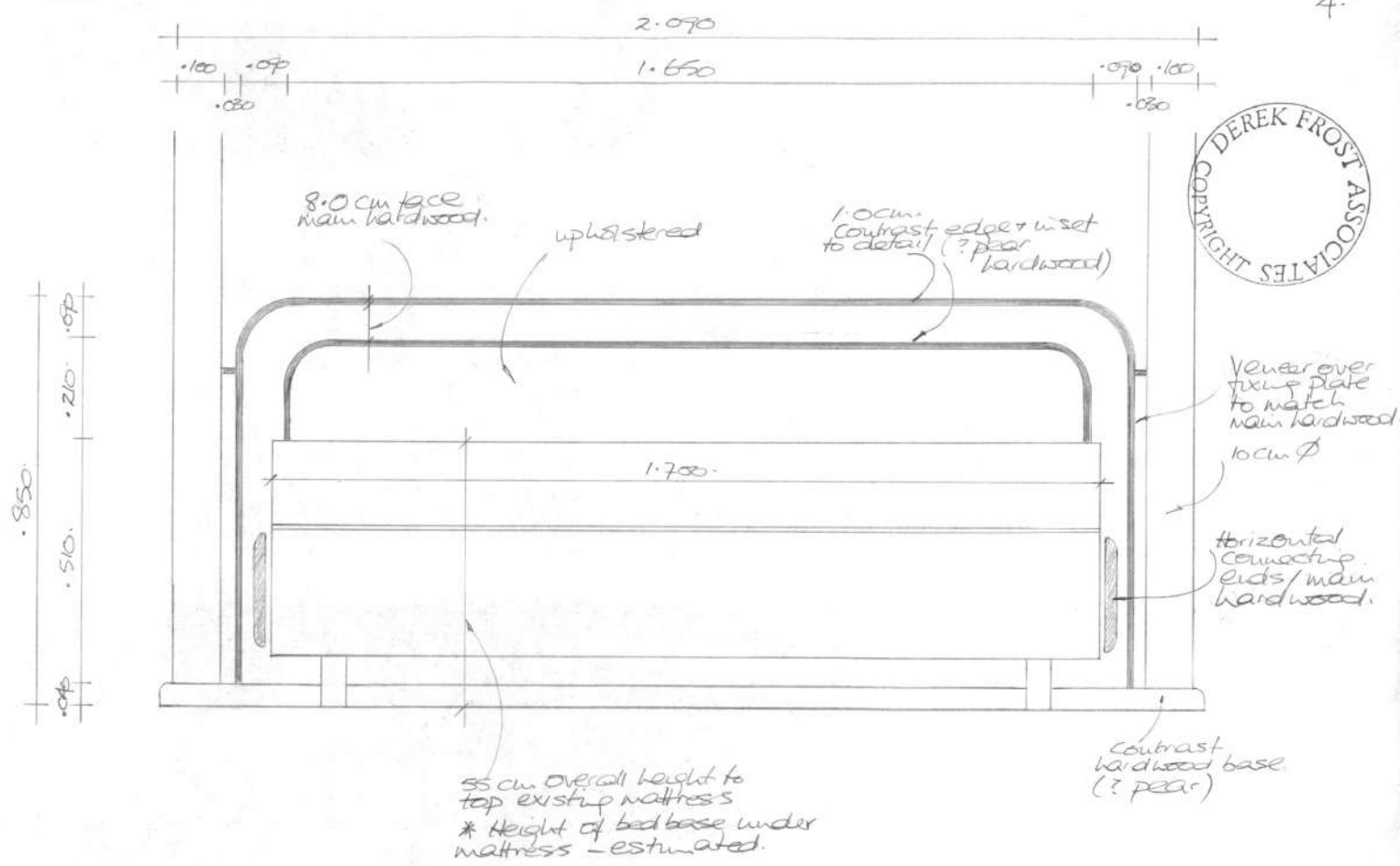

Bed for Simon + Françoise

Scale: 1:10  
date: June '89.

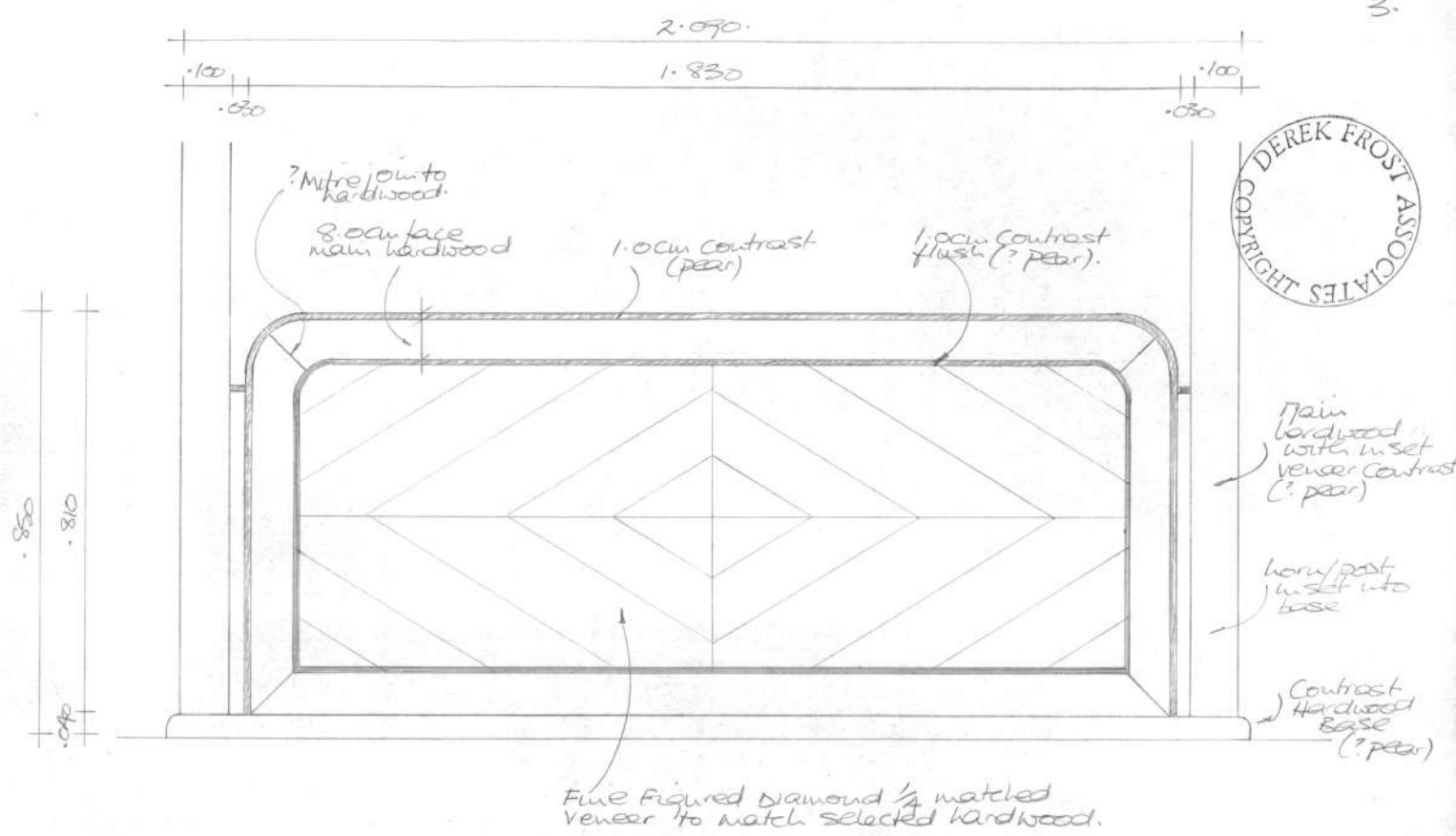

Elevation Outside Face.  
Bed for Simon + Françoise

Scale: 1:10  
date: June 189.

Use contrast veneer in place of gilded lines as alternative.

5

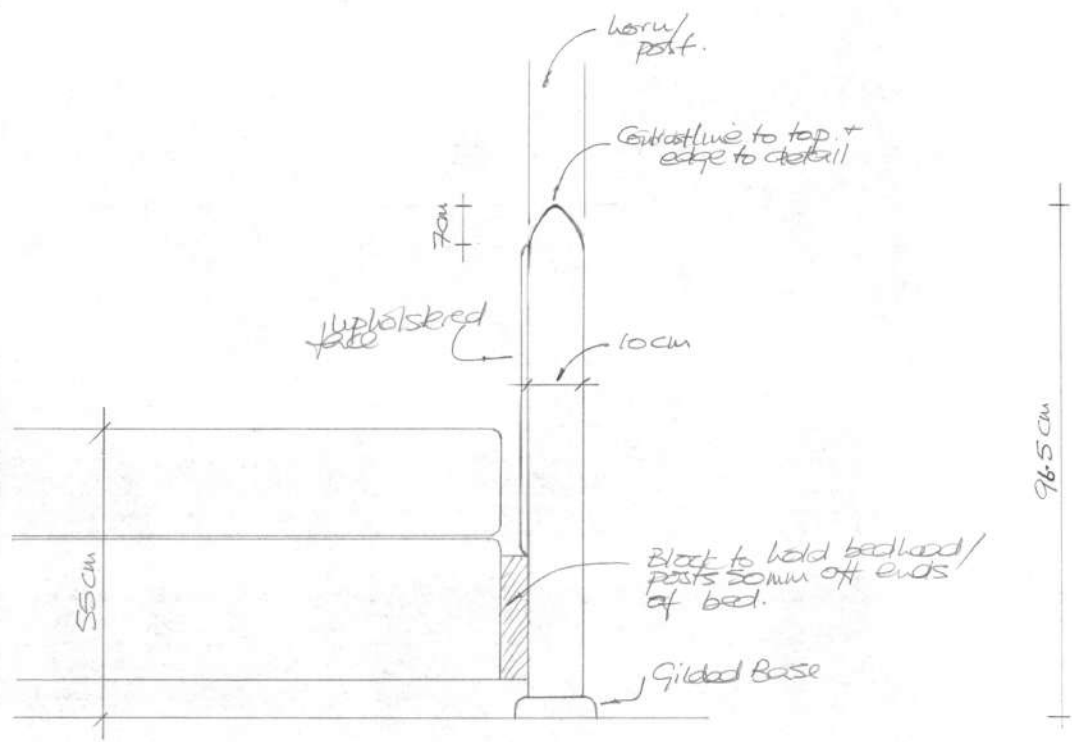

Bed for Simon + Fra-çoise  
Thornton.

Scale 1:10  
date May '89.

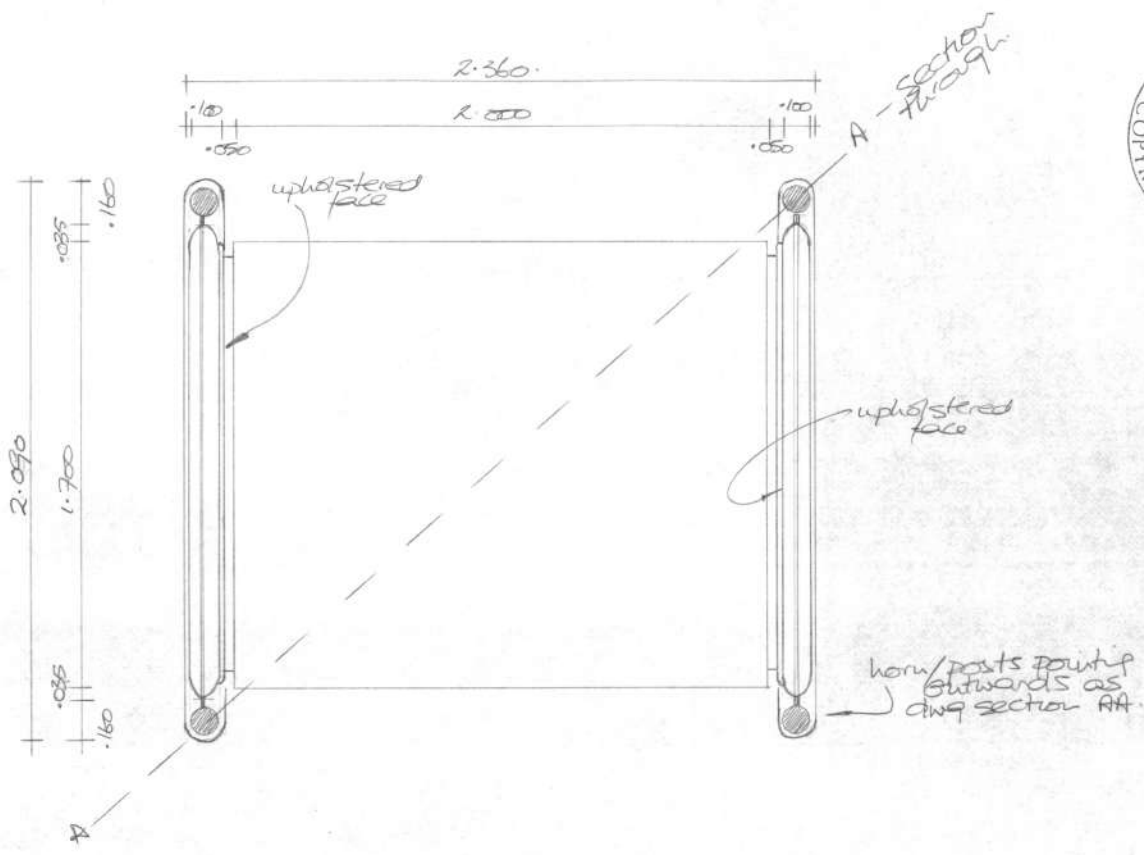

PLAN - Bed for Simon + Françoise  
 at Monkton  
 A (no.) horn/posts

scale 1:20  
 date June '89.



Bed Head to be Identical at both ends of bed.

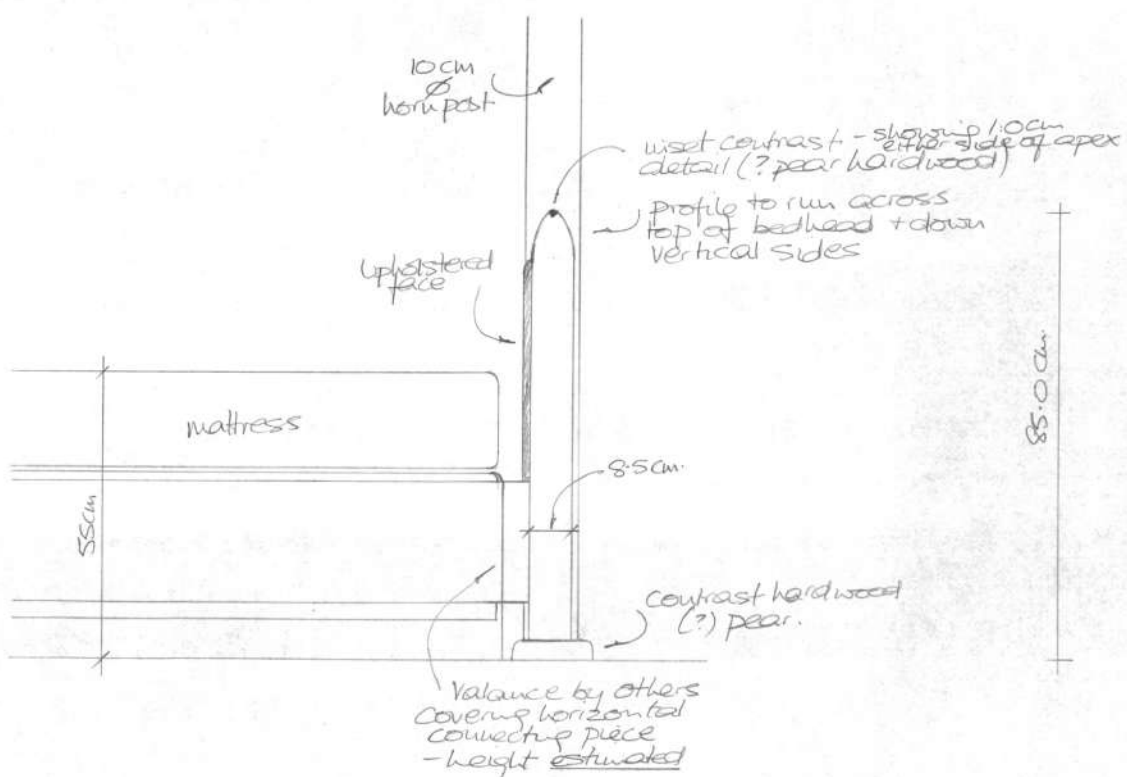

Bed for Simon + Françoise

scale 1:10  
date June '89

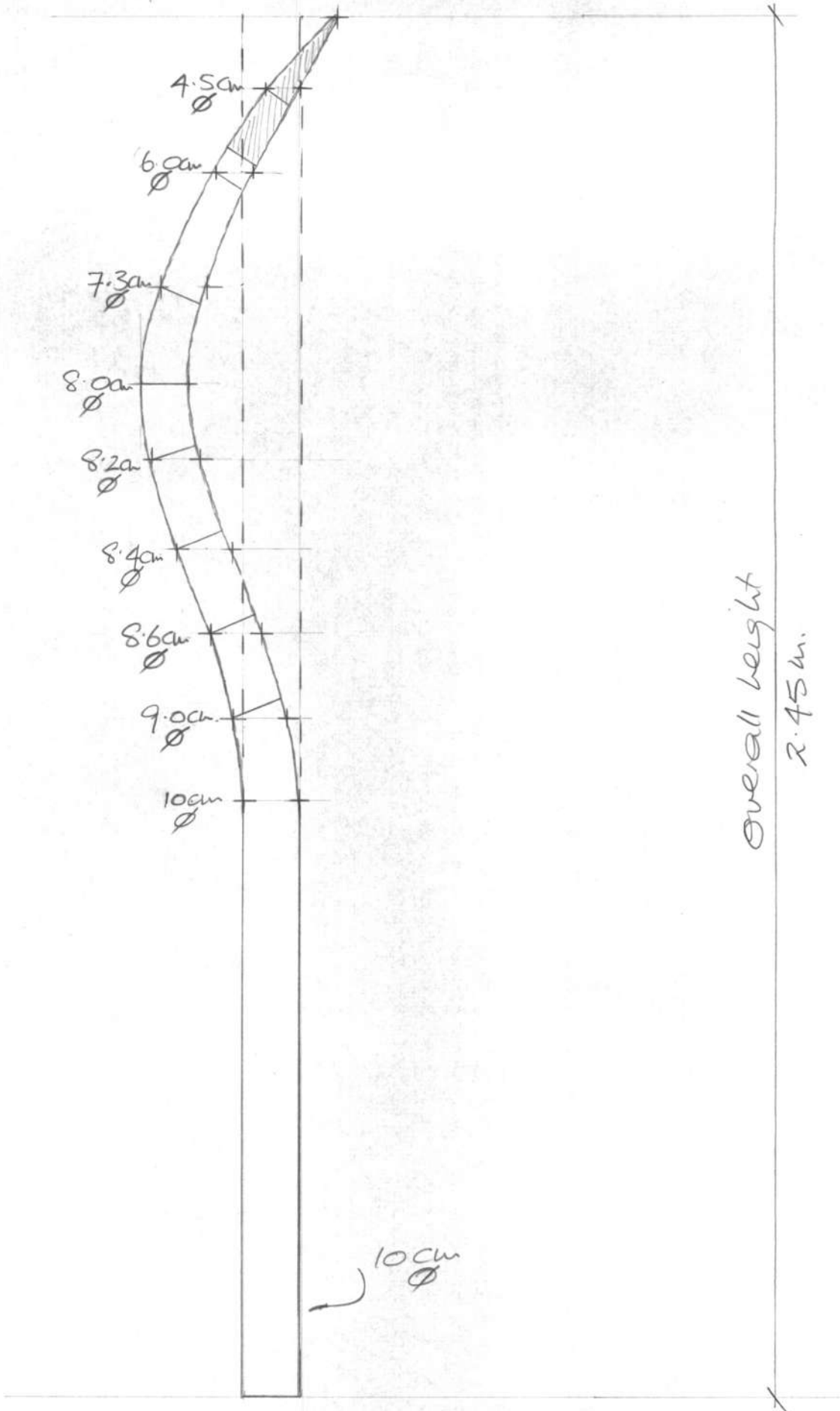

Horn Bed

Scale 1:10  
date Sept. '89.





**DC**

**Levine**

**Skyscraper Cabinet**

**London**

A fairly classical /  
slightly chinese  
sky scraper

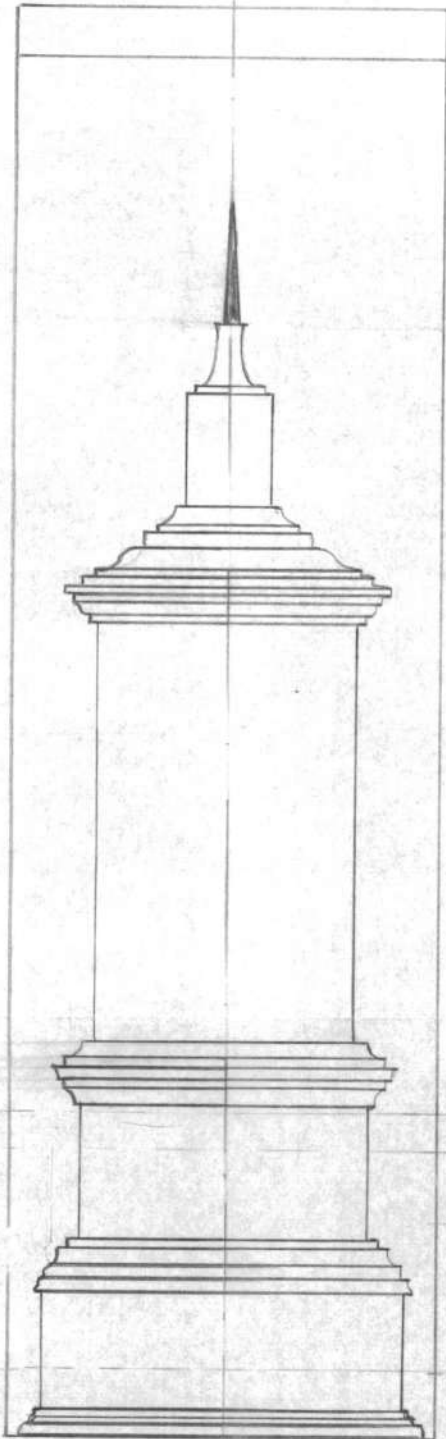

Level  
2.

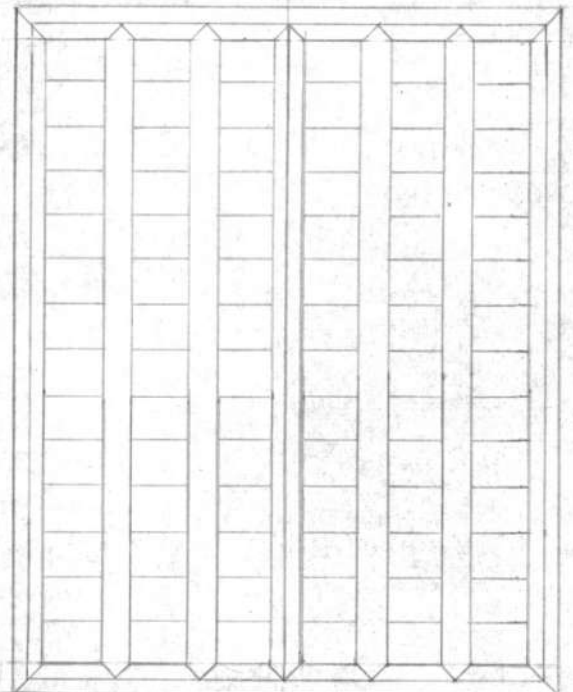

1:20  
Feb '89

Levine  
Skyscraper  
Cpbd..

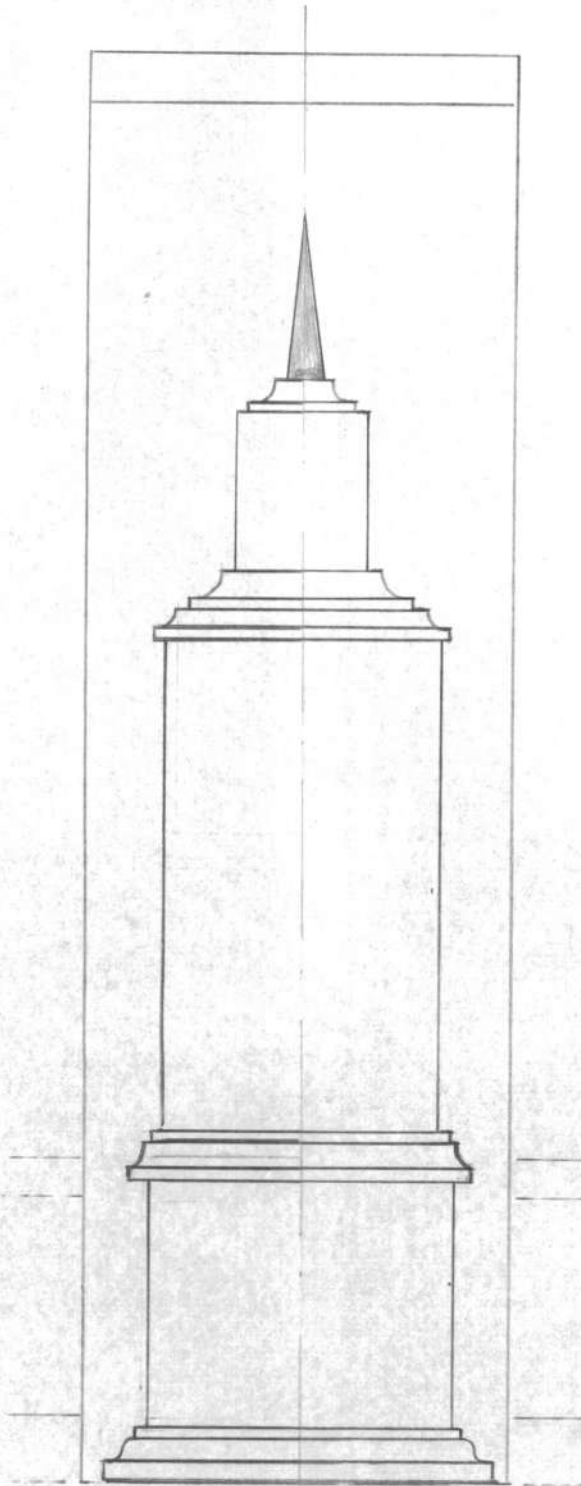

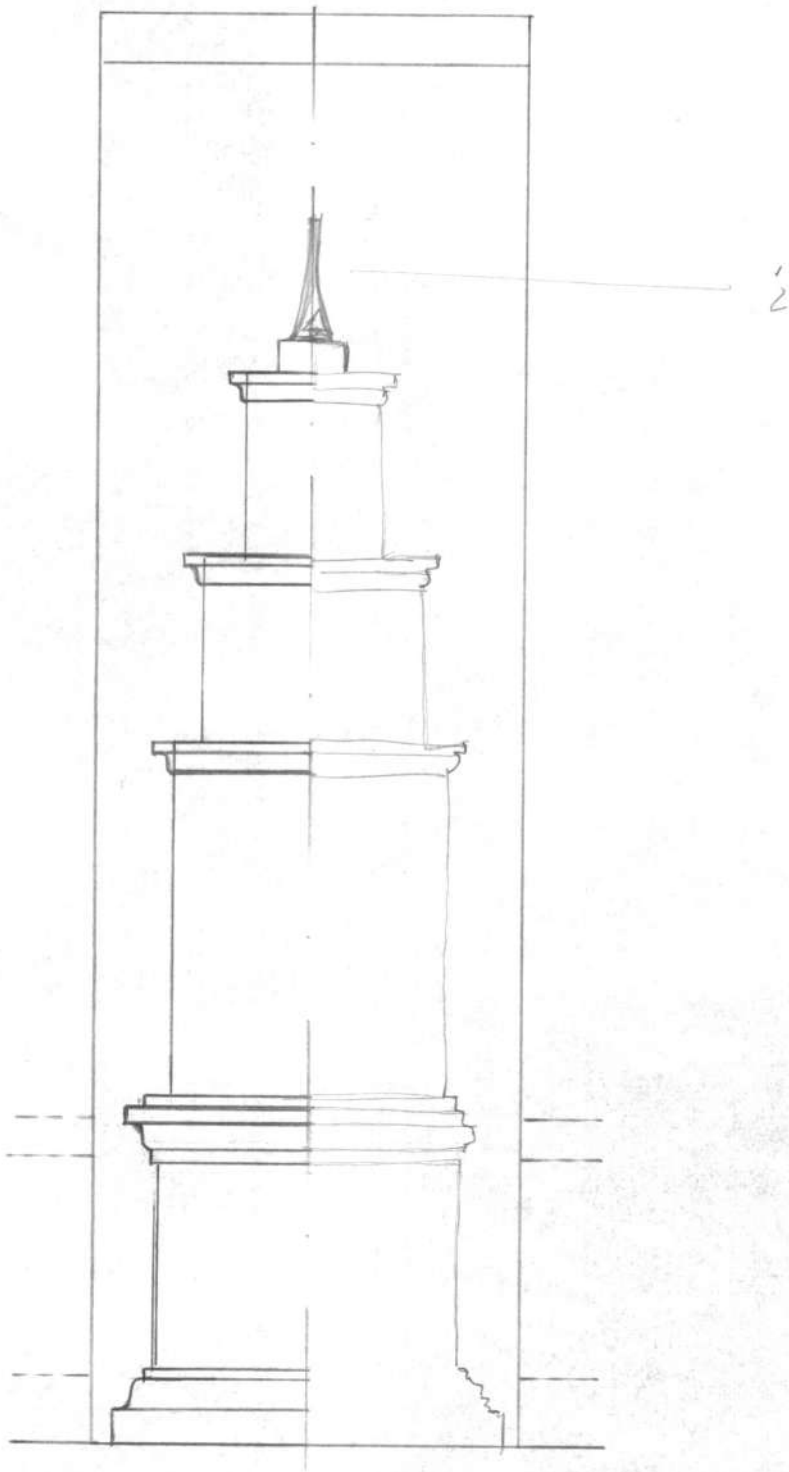

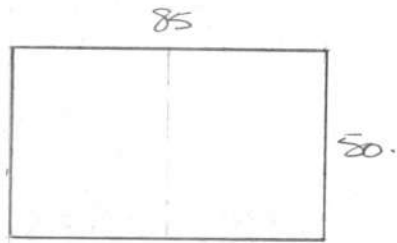

Bit too  
classical.

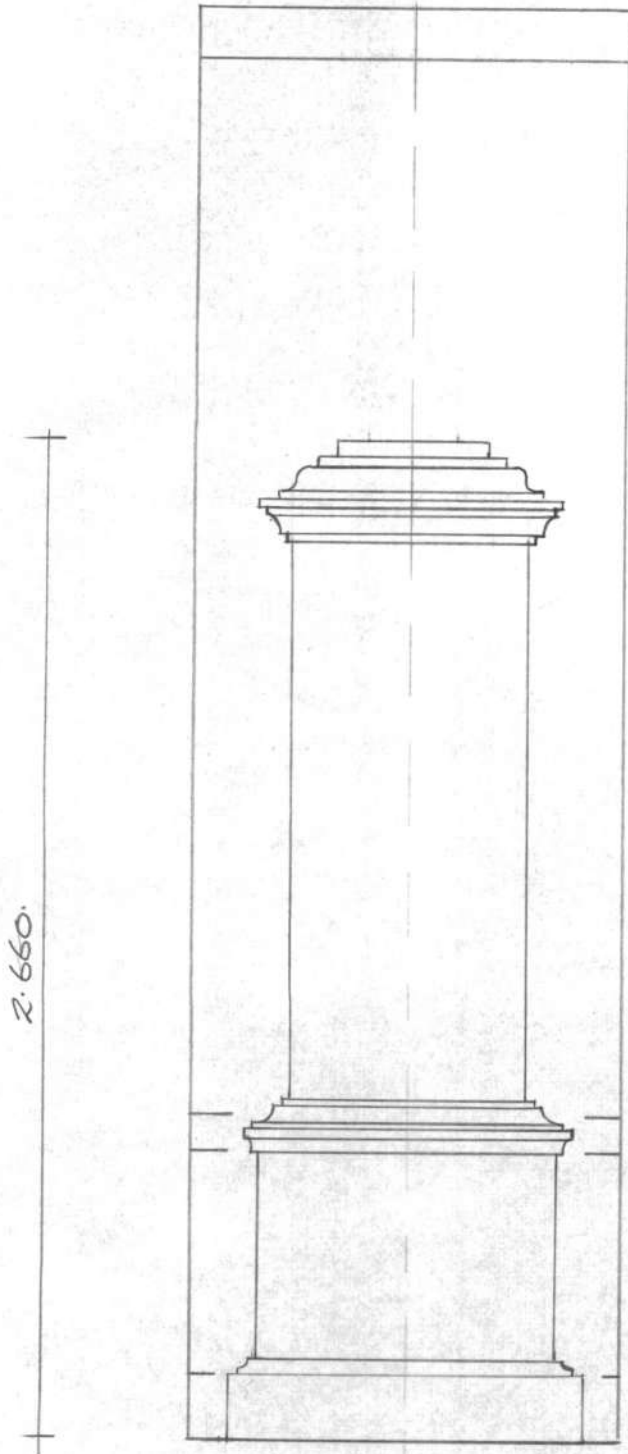

Centre  
line

Skycraper Cabinet  
Possible Shape.

Scale 1:20.  
date Feb '89.





3 m. tall  
Storage  
Cabinet /  
painted  
cabinet + drawers  
under.

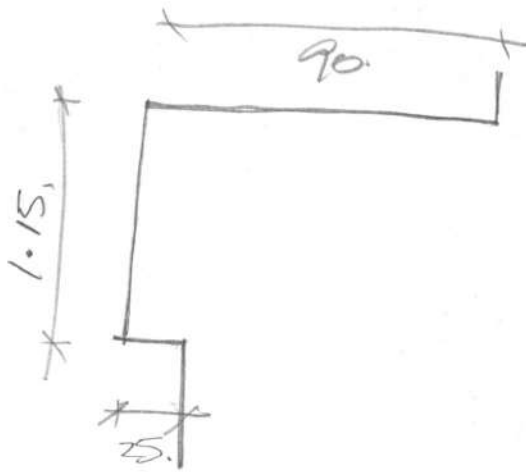

Period likes 40"  
30's

Optimum Size  
90 w x 50 dp.

Anne Smith.  
W Chalon

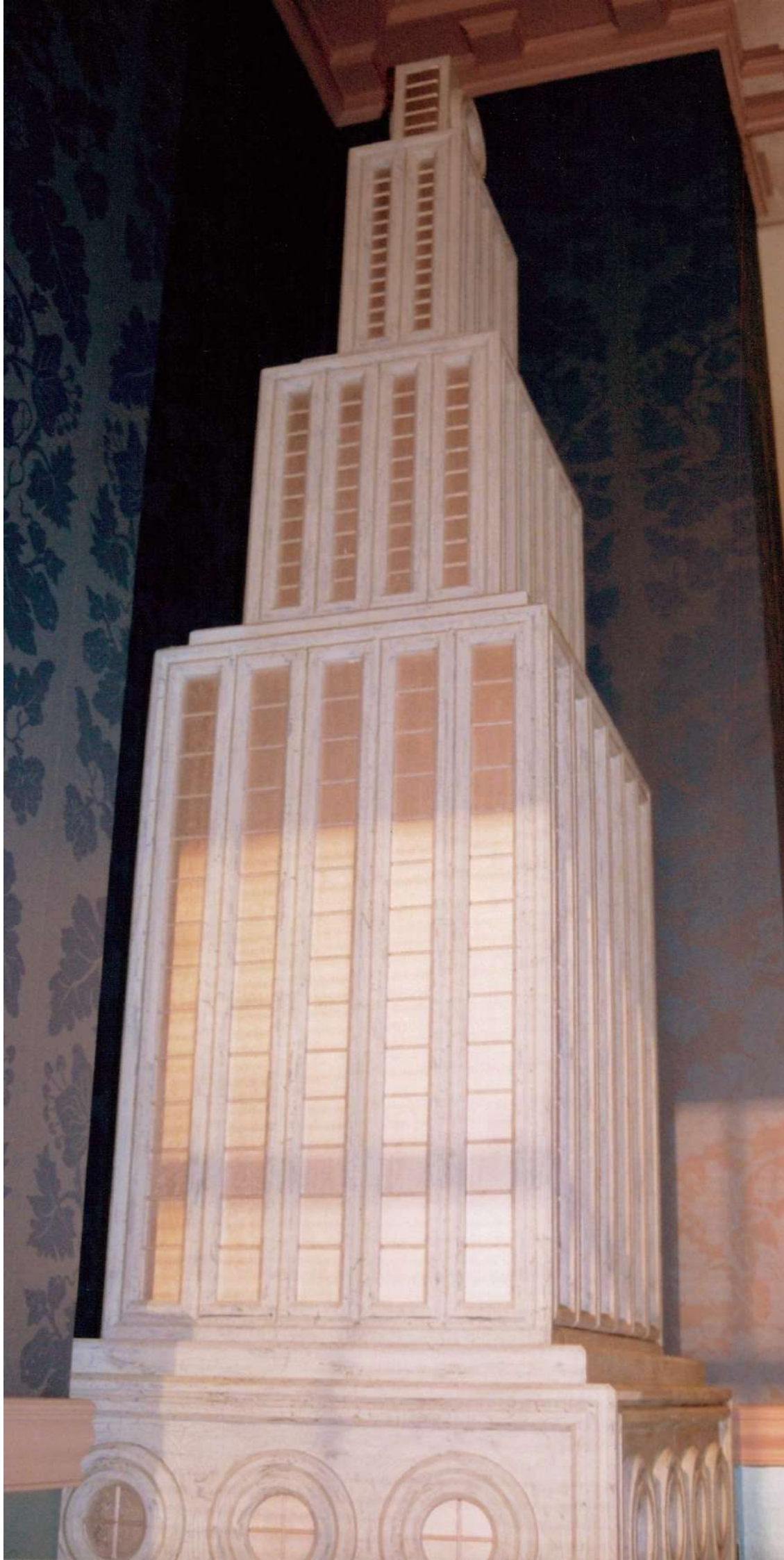

**DD**

**Designer / Ismestieff**

**3 Colours 3 Curves**

**London**

(2E)

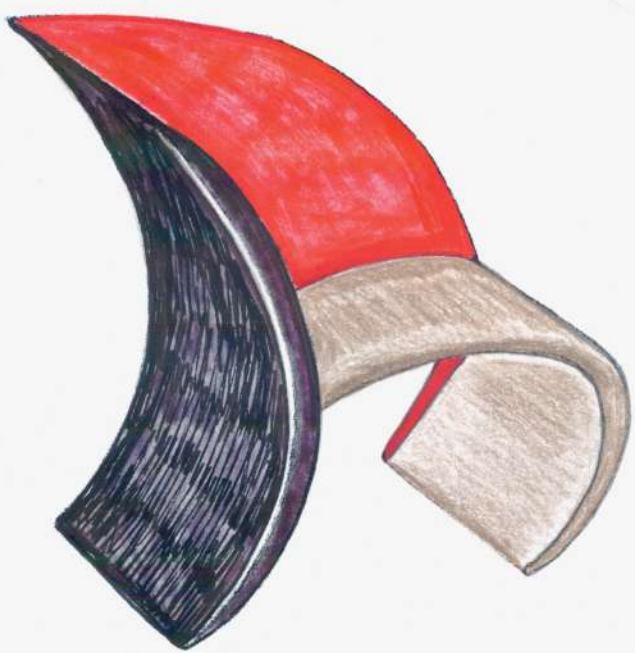

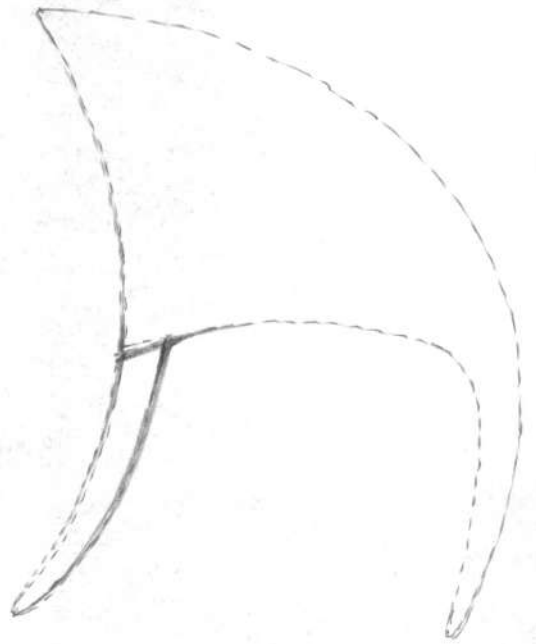
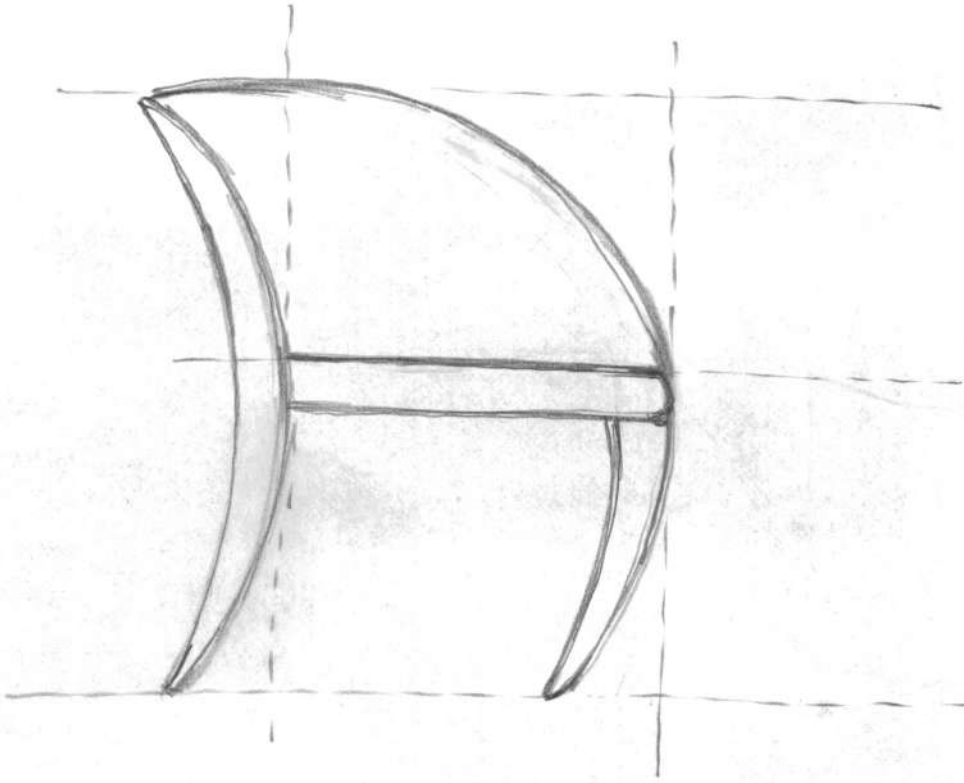

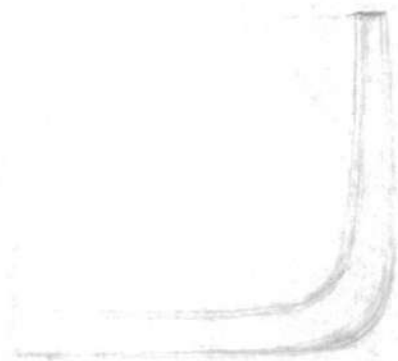
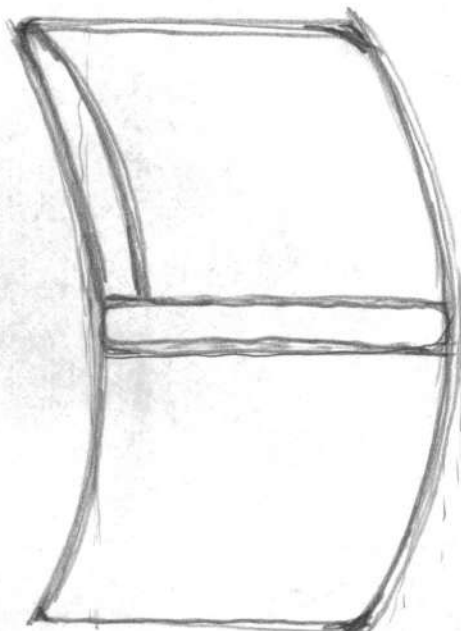
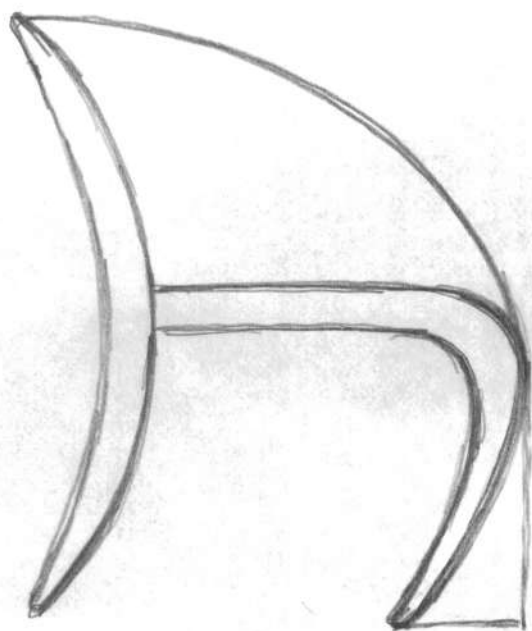

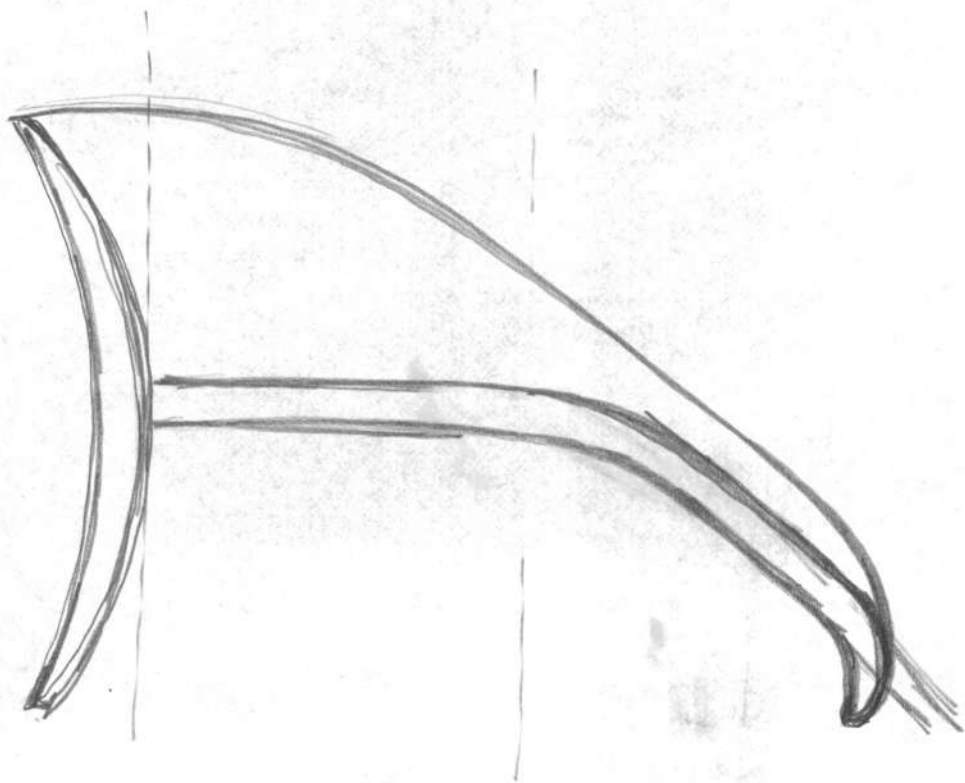



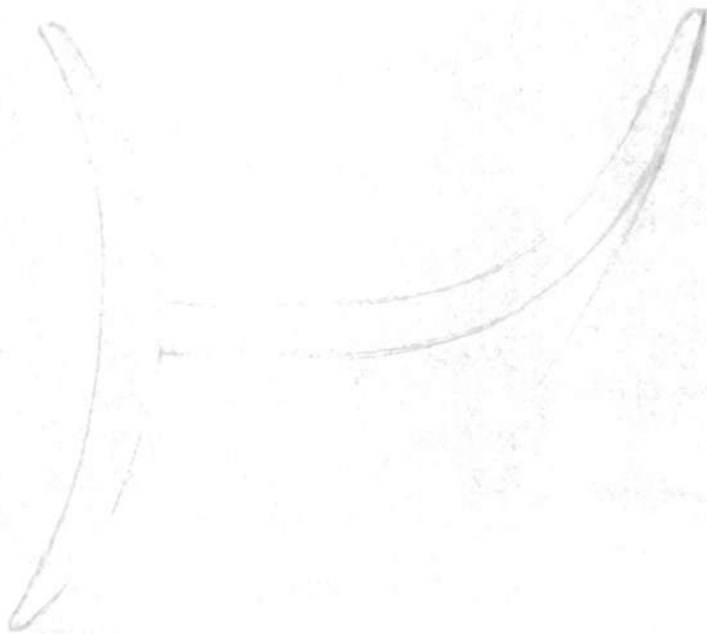
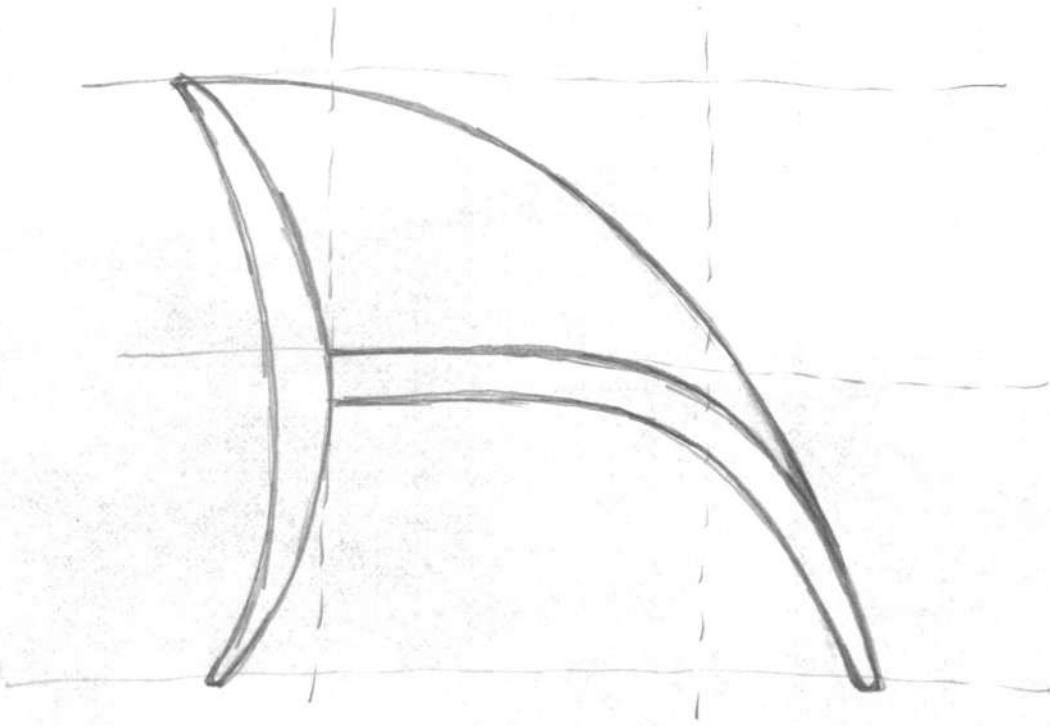



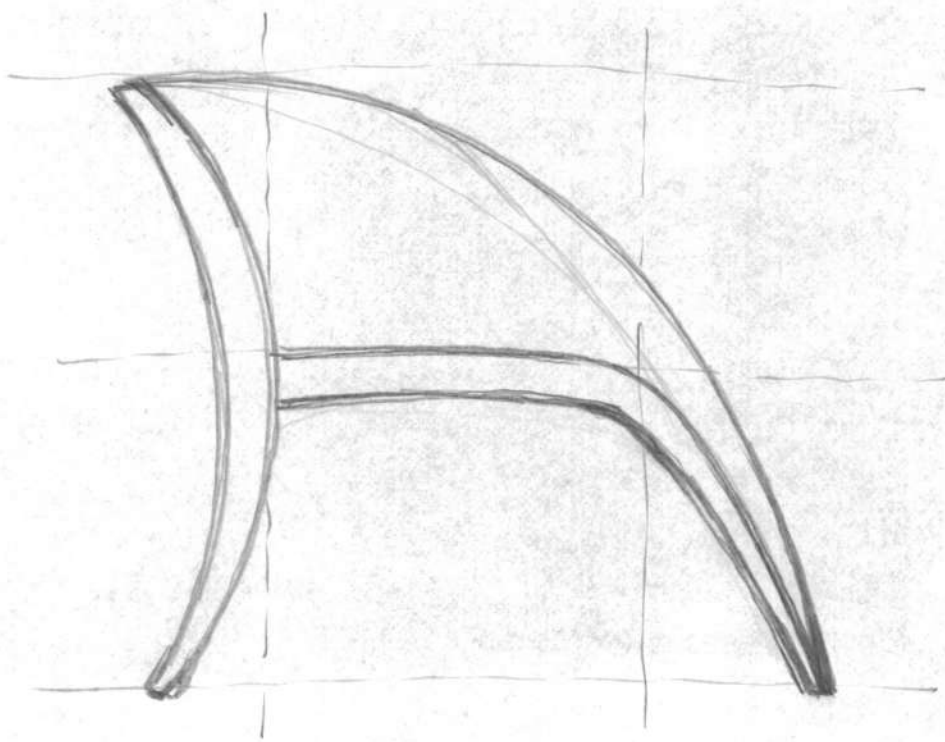

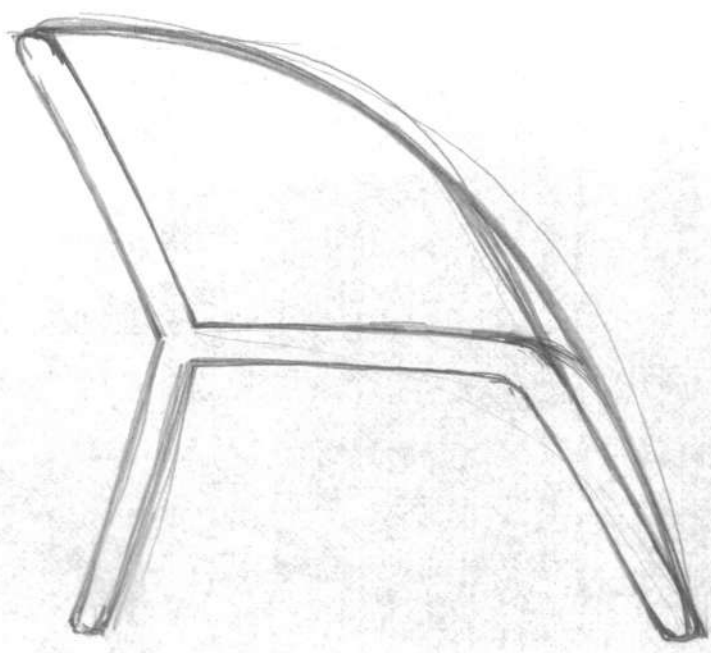

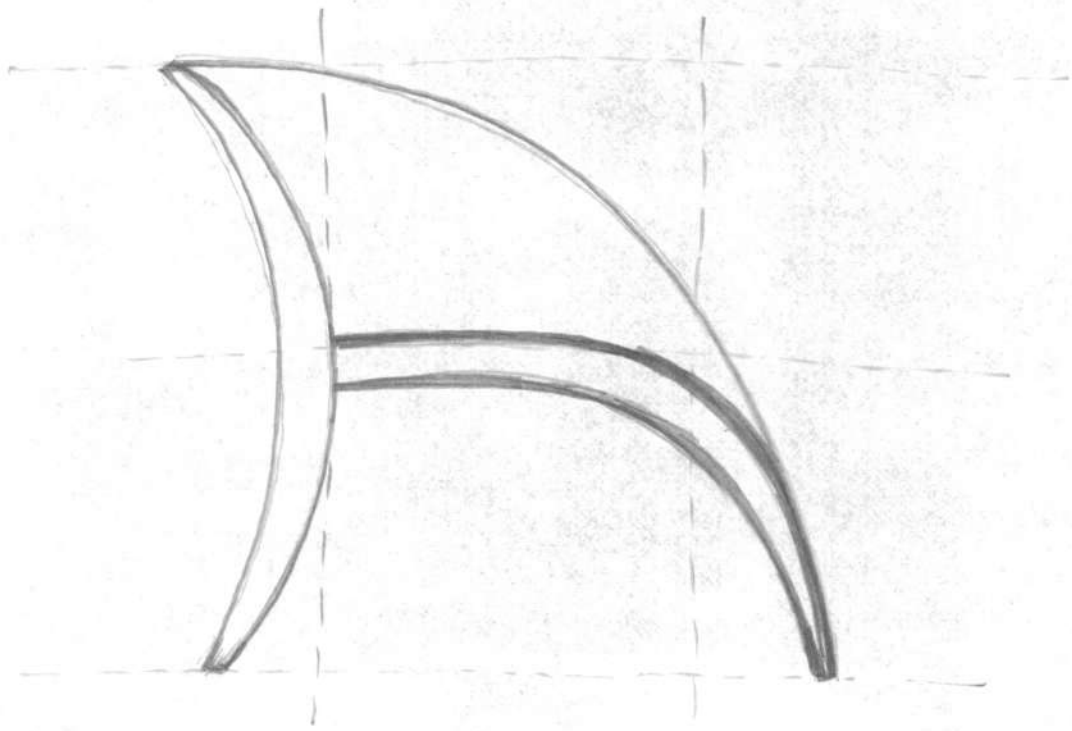

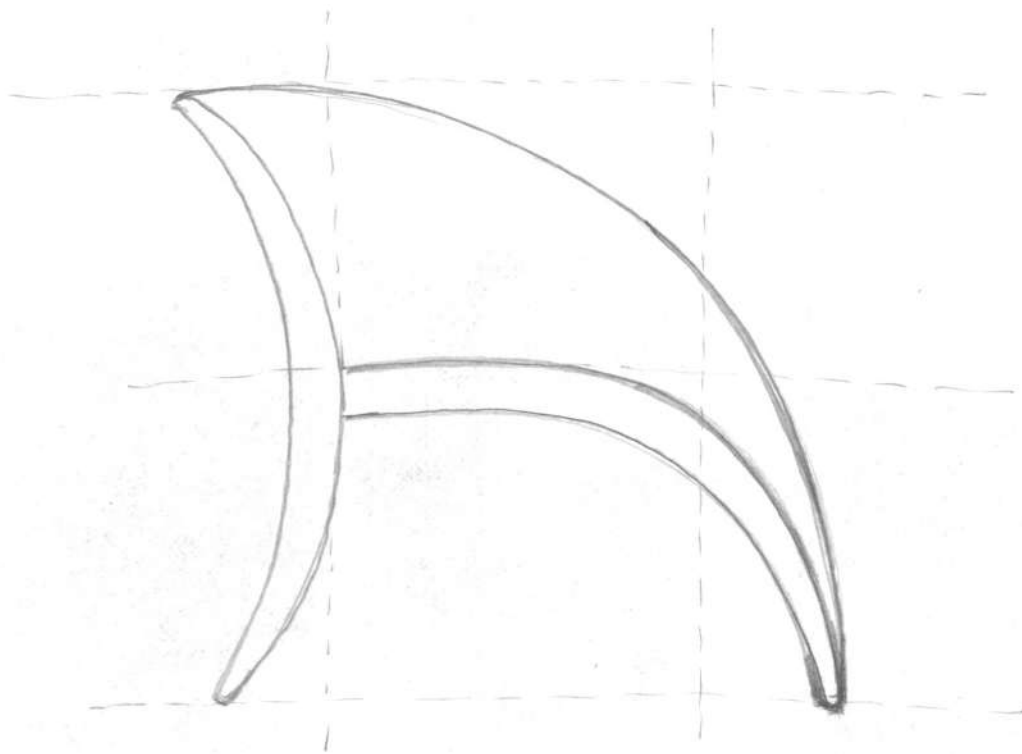

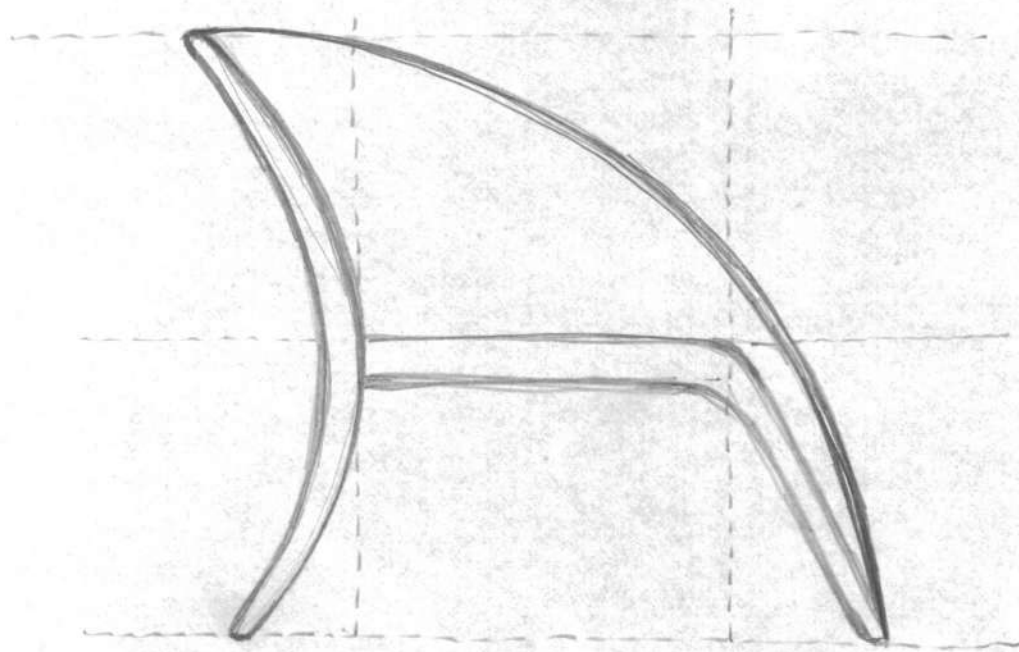

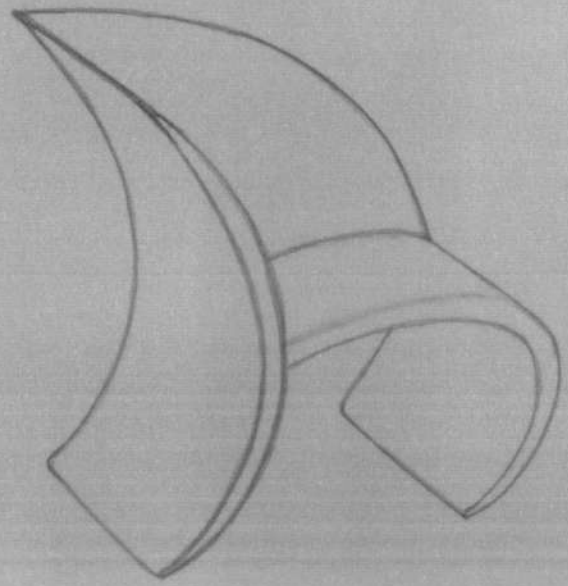

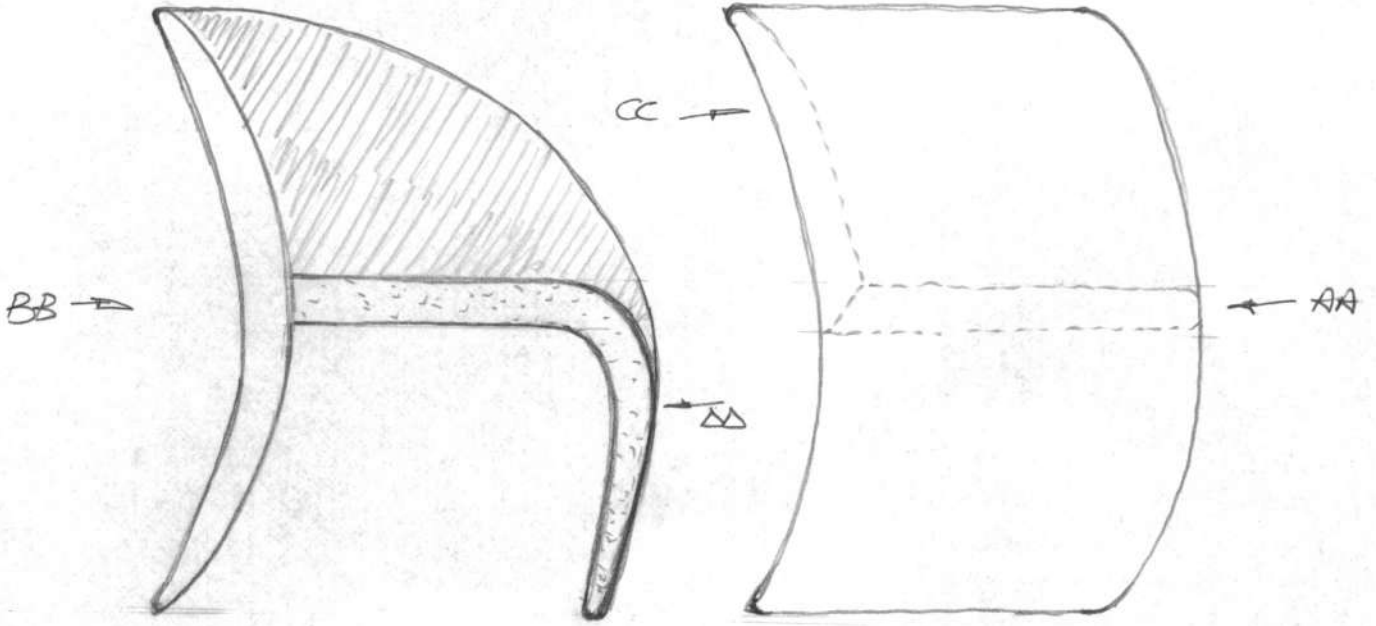

AA Elev

BB Elev

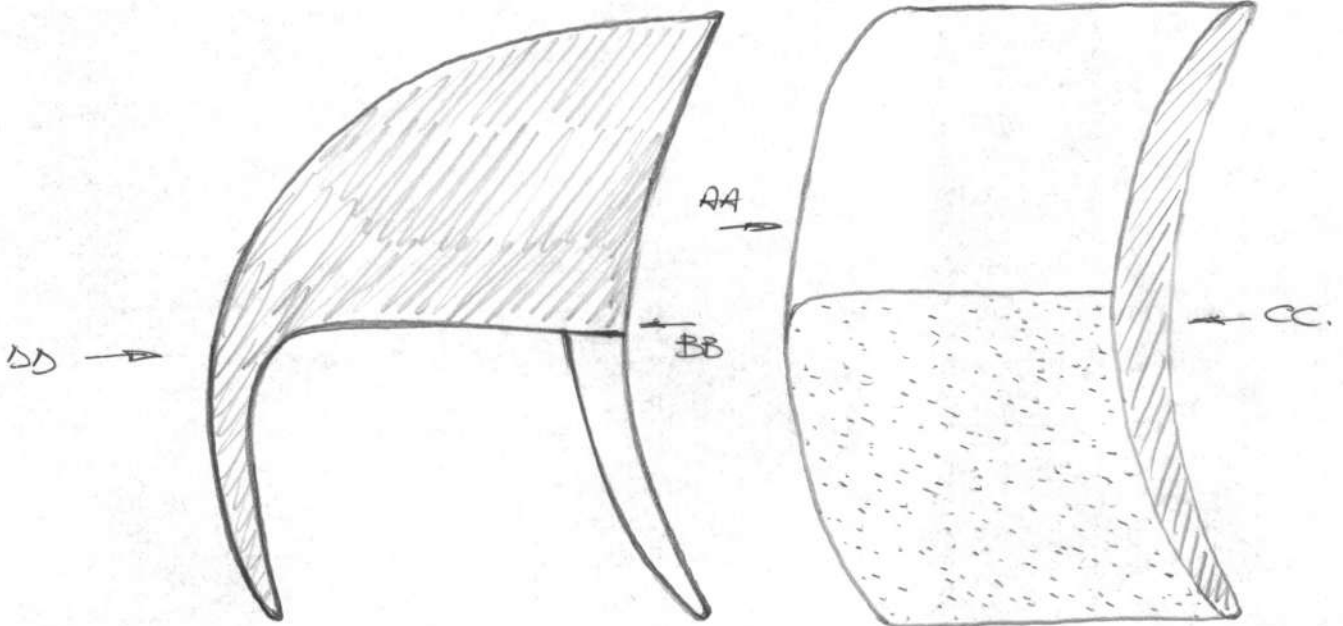

CC Elev

DD Elev

A chair for Joseph

1:10  
March '89.

